



SANY
AMERICA INC.

SCC8300
Product Guide



FEATURES

- 330 US T Capacity @ 18 ft. Radius
- 42 ft 7 in. - 137 ft 9 in. Fixed Jib Length
- 59 ft 1 in. - 216 ft 6 in. Luffing Jib Length
- 310 ft Max Tip Height (H Main Boom)
- 33,069 lbs Main Winch - Rated Line Pull

ULTRA CAB



The Ultra Cab, designed by Porsche, maximizes glass space for optimal operator visibility. The working lights and light bar are standard and well positioned. Equipped with adjustable seats and air conditioner. The cab can have a 20° upward angle, and be rotated to the front of platform. Both overhead and bottom view to expand the operating view of drivers and operational safety.

SANY DESIGNED LMI

SANY designed LMI is prominently displayed. It is user friendly, simple to set up and operate. The console also features large TV monitors.



HIGH QUALITY, NAME BRAND COMPONENTS



Cummins engine coupled to **Rexroth** hydraulic components deliver high reliability and consistent performance.

SCC8300



- Engine: Cummins QSM11, 400 hp @ 1800 rpm
- Hydraulic system: Rexroth pumps and drive motors
- SANY-designed LMI with large display screen
- Ultra Cab, styled by Porsche Design Studios
- Seven configurations available for main boom, fixed jib, and luffing jib
- Key standard features
 - Main drum bail limits
 - Main drum and rear counterweight camera system
 - Basic machine lighting package
 - Aircraft warning light

Maximum Capacity @ Radius	330 US T @ 17 ft
Main Boom	3,6 & 11.5 Meter Sections 65 ft 6 in. - 301 ft 10 in.
Max Tip Height (H Main Boom)	304 ft
Fixed Jib Length	42 ft 8 in. - 137 ft 9 in.
Luffing Jib Length	59 ft 1 in. - 216 ft 6 in.
Main Winch - Rated Line Pull	33,069 lbs
Wire Rope Diameter	28 mm
Weight	
Base Machine (Without Track Frames or Boom)	99,200 lbs
Total Counterweight	407,856 lbs
Length	
Base Machine - Transport	41 ft 10 in.
Height	
Base Machine - Transport	10 ft 6 in.
Width	
Base Machine - Transport	9 ft 10 in.
Tail Swing	23 ft

UPPERWORKS

ENGINE

Cummins Model QSM11, Tier 3
 Power..... 400 hp (298kW)
 Fuel Tank 277 gal (1048L)



HYDRAULIC SYSTEM

Includes: hoisting system, travel system, swing system, luffing system, backstay system, cooling system, auxiliary hydraulic system, and servo hydraulic system. Open loop circuit for main system and close loop for swing system. Automatic load centering function. Electric-over-hydraulic control components are used. Micro-motion control available. Three 211 gallon oil return filters with multiple pressure alarm, filter plugging alarm, and counterbalance valve for each open circuit motor. 225 gallon hydraulic reservoir with two 120-volt, 1.5kw heaters. Oil-pneumatic cylinders for backstay; compression extent in proportion to backstay force; maximum backstay force for main boom is 90,400 lbs and maximum backstay force for front strut of luffing jib is 68,350 lbs.



CONTROLS

Advanced SYMC (SANY Motion Controller), Rated Capacity Limiter (RCL) and CCTV (Closed Circuit TV) monitoring system are used. The RCL display (8.4"), CCTV display (7"), integrated instrument display (8"), etc., is readily visible to the operator. CAN bus is used to transfer data among the controllers, displays operating handles, engine and RCL.



DRUMS

The displacement hydraulic motor drives the planet gear speed reducer to raise and lower the load.

Rope Diameter 28 mm
 Max Line Speed 466 ft/min
 Single Line Pull 33,000 lbs
 Max Spooling Main 2,329 ft
 Whip 1,772 ft



SWING SYSTEM

Single motor with large displacement and planetary gear reducer, automatic load centering and 360° rotation.

Maximum Swing Speed..... 1.85 rev/min
 Tail Swing..... 21 ft. 1 in.

COUNTERWEIGHT

SERIES 1

1 – Upperworks Tray 35,274 lbs
 8 – Upper Side Block 141,096 lbs
 (17,637 lbs each)
 Total 176,370 lbs

SERIES 2

1 – Upperworks Tray 35,274 lbs
 14 – Upper Side Block 246,918 lbs
 (17,637 lbs each)
 2 – Lower Tray 55,116 lbs
 (27,558 lbs each)
 4 – Carbody Block..... 70,548 lbs
 (17,637 lbs each)
 Total 407,856 lbs



ULTRA CAB

All-enclosed steel frame structure; reinforced glass is installed at the front and back; GE structural plates are installed on the top, providing good light transmission, high strength and high abrasion resistance, and low indoor noise (below 85dB). Inside includes fire extinguisher and alarm device, and CCTV monitoring system, etc. One 24V USB port, Ergonomic design, Broad view with maximum elevation of 25°.



ATTACHMENTS

HEAVY-LIFT MAIN BOOM (H)

Max Boom Length 302 ft (92.1 m)
 Max Boom Combination 1 – 9'10" (3m) insert
 2 – 19'8" (6m) insert
 5 – 39'5" (12m) insert

FIXED JIB (FJ) STANDARD

Max Std. Fixed Jib Length... 59 ft (18 m)
 Max Std. Fixed Jib Combination
 1 – 19'8" (6m) insert
 2 – 37'9" (11.5m) insert

LOWERWORKS

CARBODY

High-strength steel frame structure. Hydraulic cylinder drives power pin.

CRAWLERS

Of 3'8" wide, the crawler is tensioned with a hydraulic cylinder and held in place by a quantity of shims.

Travel speed
 Low Speed 0-0.3 mph
 High Speed 0-0.8 mph



FIXED JIB HEAVY (FJH)

Max Heavy Duty Fixed Jib Length 138 ft (42.1 m)
 Max Heavy Duty Fixed Jib Combination 1 – 19'8" (6m) insert

LUFFING JIB

Max Jib Length 217 ft (66 m)
 Max Luffing Jib Combination
 2 – 19'8" (6m) insert
 3 – 39'5" (12m) insert

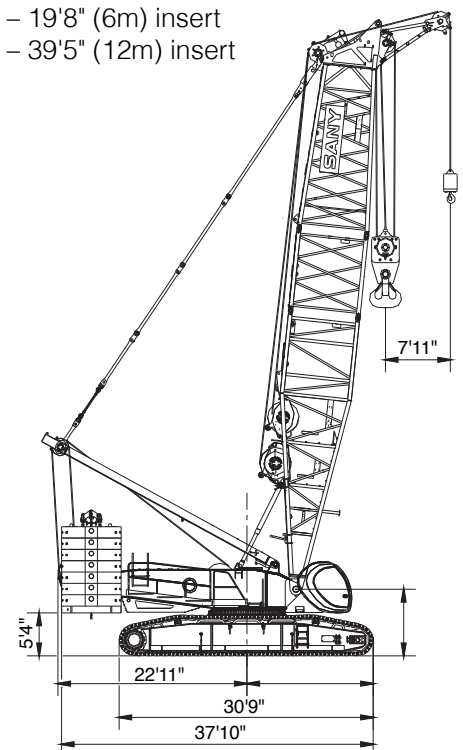
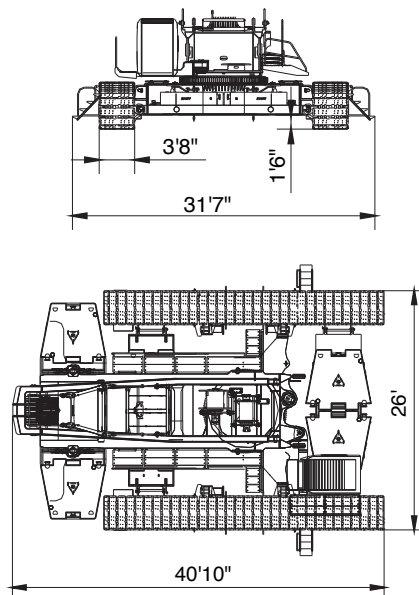

A-Frame Alarm Device

In installation mode, if a-frame does not rise into correct position, the system will alarm and the operator and work mode functions will be inoperative.

Aircraft Warning Light

Installed on the top of the boom or jib.

Anemometer

Installed at the top of boom or fixed jib for real-time monitoring of wind speed and transmission of data to operators cab for display on monitor.

Anti-Two Block (ATB)

Composed of limit switch and actuation weight on load lines to prevent excessive raising of hook block. When the lifting hook raises to its maximum height, a limit switch will activate the buzzer on the control panel, meanwhile the indicator light will blink and automatically stop the lifting operation of hook block.

Bail Limits

Composed of a mechanical arm with roller riding on the drum wire rope and proximity switches to inform the operator when 3 dead wraps are remaining. The system will alarm through a buzzer and alarm information will be displayed in the instrument cluster and automatically stop the drum movement.

Boom Stop

Composed of a spring cushioned boom stop and automatic boom stop to prevent exceeding backwards boom angle limits.

Boom Elevation Device

When the boom angle is greater than 81°, the buzzer will alarm, and boom control lever will be deactivated. This protection is controlled by a torque limiter and position switch. When the boom angle is less than 30°, an alarm will activate and display information in the control panel and automatically stop operation.

Drum Locking Device

All drums are equipped with an electric locking device. Before drum operation, operator must switch to unlock before operation.

Emergency Stop Function

In emergency, press the emergency stop button to cut off power supply of the machine and stop all operations.

Function Cut-Out

If the function lock handle is not in place, all functions for operating machine will be deactivated.

Leveling Gauge

Electronic leveling gauge displaying machine angle on monitor.

Lighting

Equipped with drum lights, lower beam in front of machine, front adjustable high beam, lighting lamps in operator's cab, lighting equipment for night operation

Lightning Protection Device

Including lightning protection grounding and surge protection devices to prevent damage to electrical components under lightning strikes.

Monitoring System

Cameras: 2 cameras are equipped for monitoring drum spooling, boom hoist, and rear of machine.

Optional monitoring: variable zoom monitoring camera system on boom top monitoring the working conditions of hook block.

Optional remote control: GPS satellite positioning and gprs data transfer, device status information, statistics, monitoring and analysis of operational data and remote fault diagnosis.

Rearview Mirror

Installed on the right of the operator's cab for monitoring the rear of the machine

Swing Lock

Hydraulic power pin lock to lock the crane in front, rear, left and right positions.

Shove-Off Seat Protection

The operator must be seated for all machine functions to work

Signs for Boom Angle

Pendulum angle indicator device is located in boom base next to the cab for operator convenience.

Sound and Light Alarming Device

When engine is running, lights will flash; when traveling or swinging, alarm will sound.

Switch of Installation Mode / Work Mode

In installation mode, bail limits, boom elevation device, and torque limiter are inoperative to facilitate crane installation. In operation mode, all the safety limits return to normal.

Three-Color Load Warning Light

There is green, yellow and red load warning lights, simultaneous displaying real-time load. When the actual load is less than 92% of rated load, the green light is on; when the actual load is between 92% and 100% of the rated load, the yellow light is on, the pre-warning lights will flash and intermittent alarm will be issued; when the actual load reaches 100% of rated load, the red light is on, the pre-warning lights will flash and intermittent alarm will be issued; when the actual load reaches 102% of rated load, the machine will automatically stop hoisting functions.

Torque Limiter

A completely separate and secure computer-controlled operating system; torque limiter can automatically detect the load of cranes and the angle of boom and show its rated load and actual load, working radius and boom angle.

Components: machine, monitor, angle sensors, force sensors etc.

Functions: can display real-time rated load, actual load, working radius and boom angle, height and other data at current status of the crane and give real-time alarm if limits are exceeded.

Turn Indicating Device

When traveling or swinging, turn indicating light blinks.

Wire Rope Guides

Lifting hooks are provided with guides to ensure the wire rope is maintained in the correct sheave location.

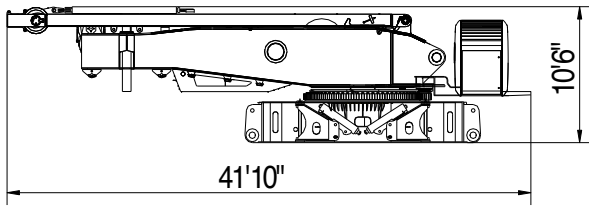

BASE MACHINE

Length	41'10"
Width	9'10"
Height	10'6"
Weight	99,200 lbs

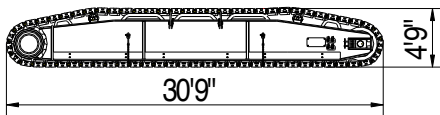

TRACK FRAME

Length	30'9"
Width	3'8"
Height	4'9"
Weight	55,100 lbs

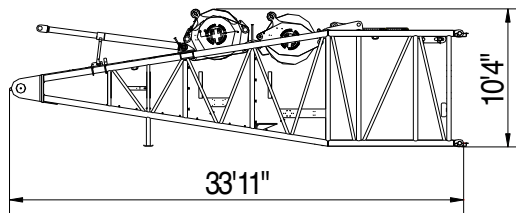

BOOM BASE #2825A (Includes Two Drums & Rope)

Length	33'11"
Width	9'7"
Height	10'4"
Weight	37,300 lbs

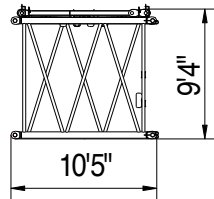

BOOM INSERT 9'10" (3m) #2825A

Length	10'5"
Width	9'7"
Height	9'4"
Weight	3,000 lbs

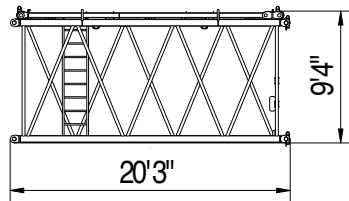

BOOM INSERT 19'8" (6m) #2825A

Length	20'3"
Width	9'7"
Height	9'4"
Weight	4,900 lbs

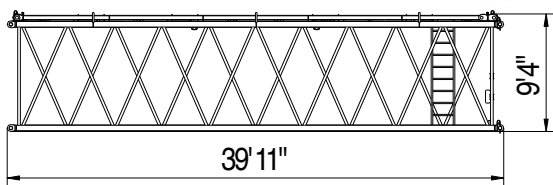

BOOM INSERT 39'5" (12m) #2825A-I

Length	39'11"
Width	9'7"
Height	9'4"
Weight	8,700 lbs

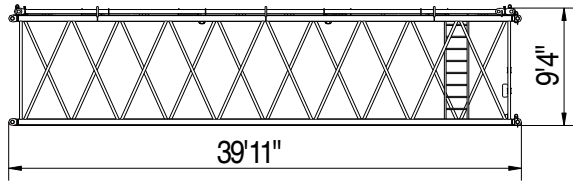

BOOM INSERT 39'5" (12m) #2825A-II

Length	39'11"
Width	9'7"
Height	9'4"
Weight	7,600 lbs

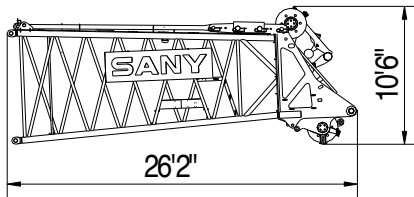

BOOM TIP #2825A

Length	26'2"
Width	9'7"
Height	10'6"
Weight	15,100 lbs

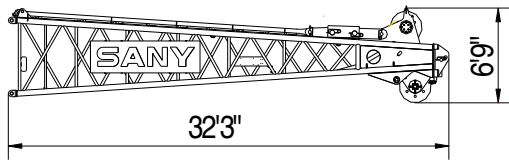

LUFFING JIB TIP 29'6" (9m) #2316A

Length	32'3"
Width	7'11"
Height	6'9"
Weight	9,800 lbs

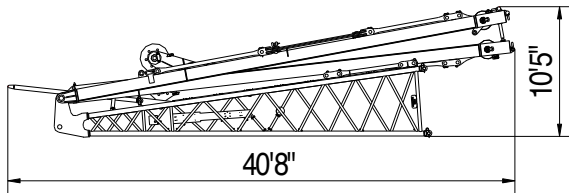

LUFFING JIB BASE 29'6" (9m) #2316A (Including Struts)

Length	40'8"
Width	7'11"
Height	10'5"
Weight	19,000 lbs

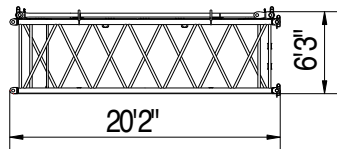

LUFFING JIB INSERT 19'8" (6m) #2316A

Length	20'2"
Width	7'11"
Height	6'3"
Weight	3,100 lbs

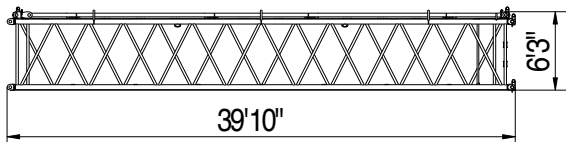

LUFFING JIB INSERT 39'5" (12m) #2316A

Length	39'10"
Width	7'11"
Height	6'3"
Weight	5,500 lbs

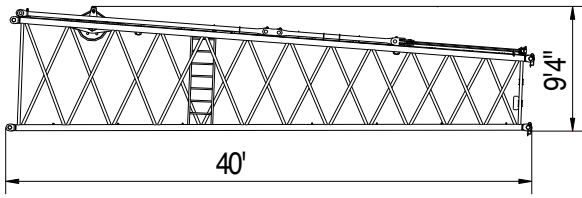

TRANSITION INSERT 39'5" (12m) #2825A /NO. 2316A

Length	40'
Width	9'7"
Height	9'4"
Weight	7,700 lbs

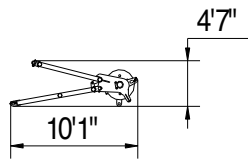

UPPER BOOM POINT

Length	10'1"
Width	3'6"
Height	4'7"
Weight	1,400 lbs

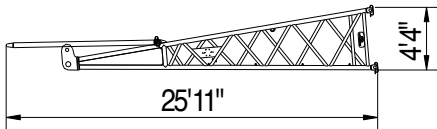

STANDARD FIXED JIB BASE 21'4" (6.5m) #1412A

Length	25'11"
Width	4'3"
Height	4'4"
Weight	2,800 lbs

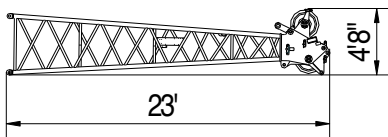

STANDARD FIXED JIB TIP 21'4" (6.5m) #1412A

Length	23'
Width	4'3"
Height	4'8"
Weight	3,100 lbs

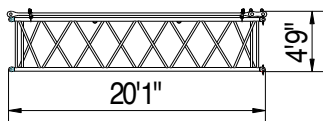

STANDARD FIXED JIB INSERT 19'8" (6m) #1412A

Length	20'1"
Width	4'3"
Height	4'9"
Weight	1,700 lbs

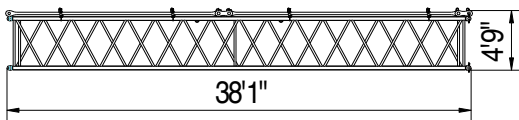

STANDARD FIXED JIB INSERT 37'9" (11.5m) #1412A

Length	38'1"
Width	4'3"
Height	4'9"
Weight	2,900 lbs

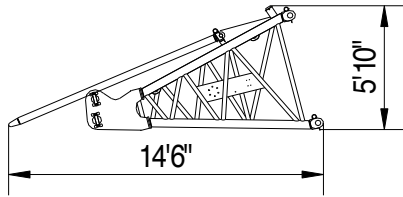

HEAVY-DUTY FIXED JIB BASE 9'9" (3m) #2316A

Length	14'6"
Width	7'11"
Height	5'10"
Weight	3,500 lbs

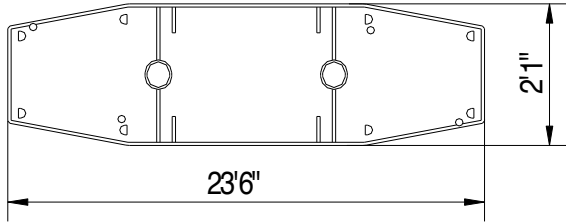

UPPERWORKS COUNTERWEIGHT TRAY

Length	23'6"
Width	7'3"
Height	2'1"
Weight	35,274 lbs

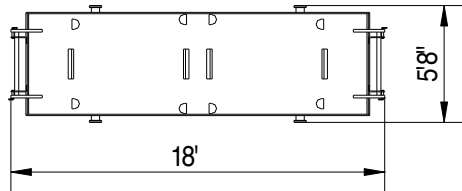

CARBODY COUNTERWEIGHT TRAY

Length	18'
Width	5'8"
Height	1'8"
Weight	27,558 lbs

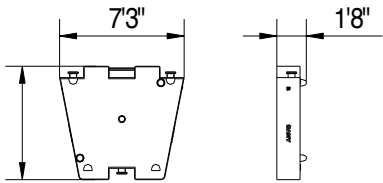

COUNTERWEIGHT BLOCK

Length	6'7"
Width	7'3"
Height	1'8"
Weight	17,637 lbs

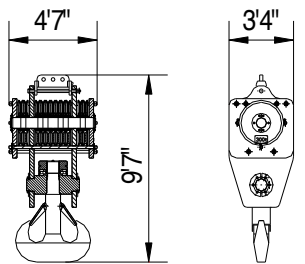

330 USt (300Mt) HOOK BLOCK

Length	9'7"
Width	4'7"
Height	3'4"
Weight	13,700 lbs

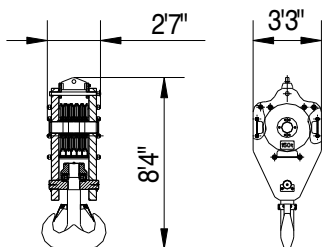

165 USt (150Mt) HOOK BLOCK

Length	8'4"
Width	2'7"
Height	3'3"
Weight	8,300 lbs

TRANSPORT DIMENSIONS

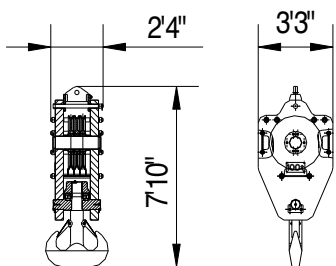

110 US St (100Mt) HOOK BLOCK

Length	7'10"
Width	3'3"
Height	2'4"
Weight	7,100 lbs

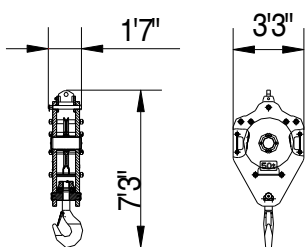

55 US St (50Mt) HOOK BLOCK

Length	7'3"
Width	3'3"
Height	1'6"
Weight	5,300 lbs

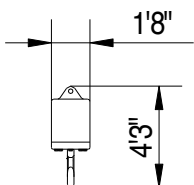

16.5 US St (15Mt) HOOK BALL

Length	4'3"
Width	1'8"
Height	1'8"
Weight	2,200 lbs

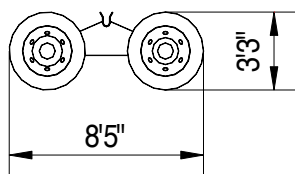

TROLLEY (LUFFING JIB)

Length	8'5"
Width	5'8"
Height	3'3"
Weight	2,200 lbs

NOTES:

1. The transport dimensions of the parts are marked on schematic diagrams, but not drawn by scale; the dimensions indicated are the design values excluding package.
2. The weight is the design value and there may be difference due to the manufacturing error.

(203' + 216') Main Boom + Luffing Jib																	
Trailer Load Out Summary																	
Name	Wt. (Klbs)	1	2	3	4	5	6	7	8	9	10	11	12	13	14	15	16
Basic Machine	99.2	1															
Crawler Assembly	55.1		1	1													
Rear Counterweight Tray	35.3				1												
Central Counterweight Tray	27.6					1	1										
Counterweight Block	17.6					1	1	2	2	2	2	2	2	2	1	1	
Boom Base	37.3																1
3M Boom Insert	3																1
6M Boom Insert	4.9														1		
12M Boom Insert	8.7							1	1	1							
Boom Tip	15.1														1		
Luffing Jib Base with Masts	19															1	
6M Luffing Jib Insert	3.1				2												
12M Luffing Jib Insert	5.5										1	1	1				
Luffing Jib Tip	9.8													1			
Extension Arm	1.4																1
150T Hook	8.3														1		
100T Hook	7.1															1	
50T Hook	5.3										1						
15T Hook Ball	2.2												1				
Trolley	2.2																1
Weight Each trailer (Klbs)		99.2	55.1	55.1	41.5	45.2	45.2	43.9	43.9	43.9	46	40.7	42.9	45	45.9	43.7	43.9

SCC8300 MAIN BOOM (H) LOAD CHART



Boom 2825A

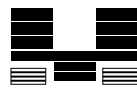

281.6 Klb

+
125.4 Klb



360°

BOOM LENGTH (ft)

LOAD RAD (ft)	66	75	95	115	135	154	174	194	213	233	253	262	292	302	
	CAPACITY (Klb)														
20	568.4	565.8													
25	477.6	470.3	457.7	447.7	385.7										
30	394.9	392.9	389.7	378.8	362.5	353.7	336.5								
35	340.8	340.0	336.0	327.2	318.6	306.1	294.5	282.0	263.1						
40	298.4	298.8	292.1	286.9	282.9	270.9	258.4	245.6	234.9	223.7	211.7	205.1			
45	263.0	263.2	258.5	255.8	248.7	240.6	230.8	221.1	211.4	204.1	197.5	194.2			
50	234.5	234.5	232.3	231.2	225.1	218.5	209.9	200.5	193.8	184.2	177.9	174.8	150.8		
55	209.5	209.5	208.9	208.2	204.2	198.7	191.3	183.0	177.5	168.1	160.1	157.0	142.1		
60		187.2	187.2	186.2	184.2	180.3	173.9	168.0	161.8	155.8	145.7	143.4	132.6		
65		167.6	167.5	167.4	167.8	165.2	159.2	154.8	148.2	142.9	133.3	132.9	123.2		
70		151.6	152.6	152.2	151.5	150.1	146.8	142.5	137.2	131.9	125.8	124.3	115.2	112.8	
75			138.9	138.4	137.4	136.7	135.0	131.4	127.0	122.0	117.8	115.7	108.1	104.9	
80			126.4	126.1	125.6	125.0	123.9	121.6	117.5	113.1	109.3	107.4	101.4	98.3	
85			116.3	115.9	115.9	114.8	113.9	112.9	109.2	105.4	101.5	99.9	94.3	91.5	
90				107.8	107.1	106.8	105.6	104.6	101.8	98.2	94.9	93.1	87.9	85.3	
95				100.0	99.4	99.2	98.0	97.0	95.0	90.0	88.5	86.8	81.9	79.3	
100				92.9	92.5	92.0	91.0	90.1	88.6	83.0	82.5	81.0	76.4	73.8	
110					74.3	79.7	78.9	78.0	76.8	75.1	72.3	70.8	66.4	64.2	
120						70.0	69.1	68.2	66.9	65.6	63.6	62.2	58.3	56.1	
130						60.6	60.6	59.8	58.7	57.3	56.2	54.8	51.1	49.1	
140							53.7	52.8	51.7	50.4	49.3	48.5	45.0	43.1	
150							46.8	46.8	45.7	44.4	43.3	42.6	39.5	37.8	
160								41.2	40.4	39.1	38.0	37.4	34.8	33.1	
170								36.1	35.8	34.5	33.4	32.7	30.6	28.9	
180									30.9	30.5	29.4	28.7	26.8	25.2	
190									27.4	26.1	25.7	25.0	23.2	21.9	
200										22.8	22.6	21.9	20.0	18.8	
210											19.0	19.0	17.0	15.9	
230												16.4	15.7	12.0	10.9
250														7.2	5.4

*This material is supplied for reference only. Operator must refer to Crane Rating Manual and Operator's Manual to determine allowable crane lifting capacities and assembly operating procedures.

(H) BOOM RANGE DIAGRAM

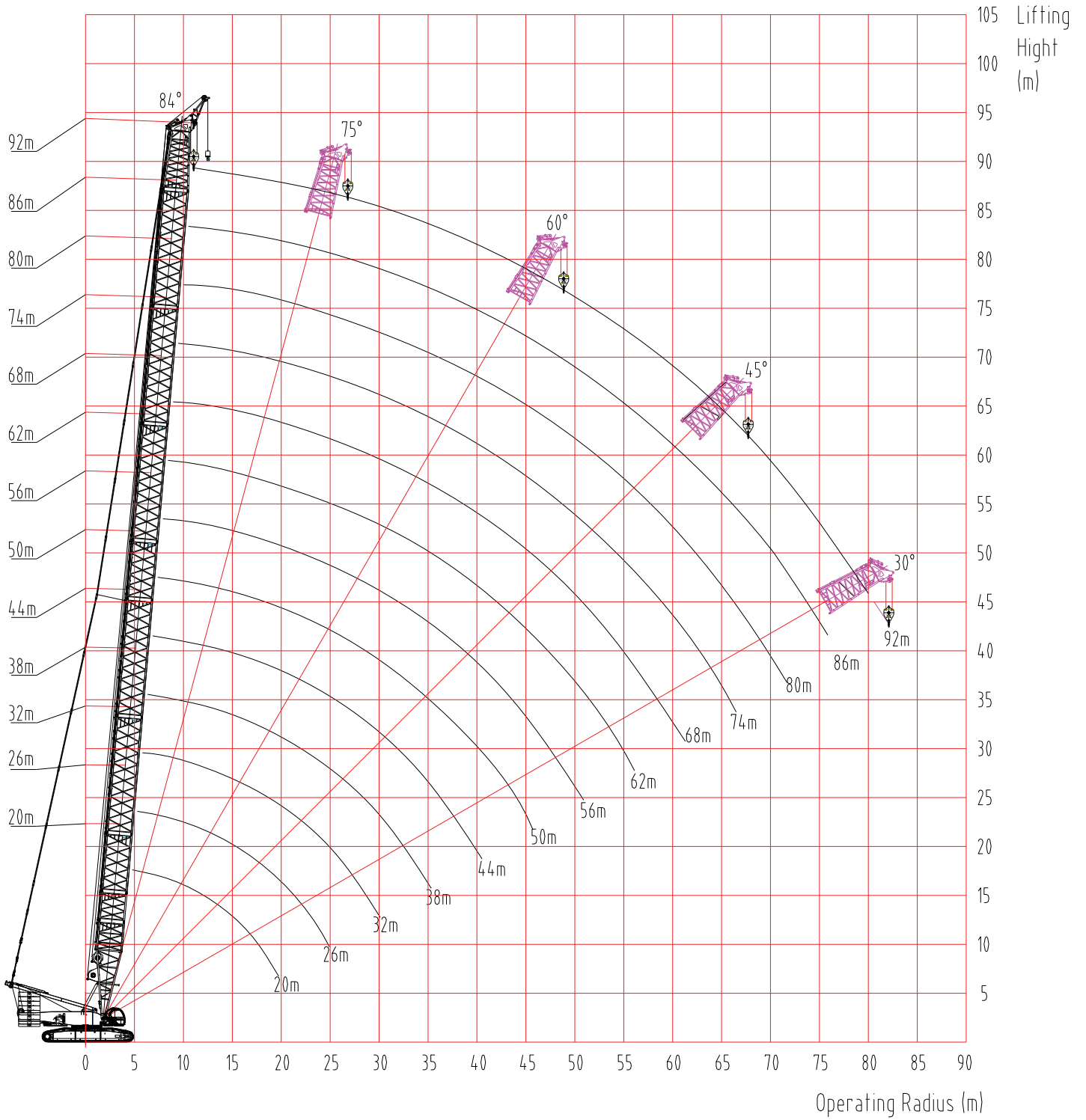

Operating Range Curve of Lifting Height

(H) BOOM OPERATING CONDITIONS

2825A Boom - H Boom Configuration						
Boom Length	Insert					
	9.8' 2825A CENTER	19.7' 2825A CENTER	39.4' 2825A CENTER I	39.4' 2825A CENTER II	6.3' SUSPENSION I	6.3' SUSPENSION II
66'	-	1	-	-	-	-
76'	-	1	-	-	-	-
95'	-	-	-	1	-	-
115'	-	1	-	1	-	-
135'	-	-	-	2	-	-
154'	-	1	-	2	-	-
174'	-	-	1	2	-	-
194'	-	1	1	2	-	-
213'	-	-	2	2	-	-
233'	-	1	2	2	-	-
253'	-	-	3	2	1	-
*262'	1	2	2	2	-	1
292'	-	2	3	2	-	1
302'	1	2	3	2	-	1

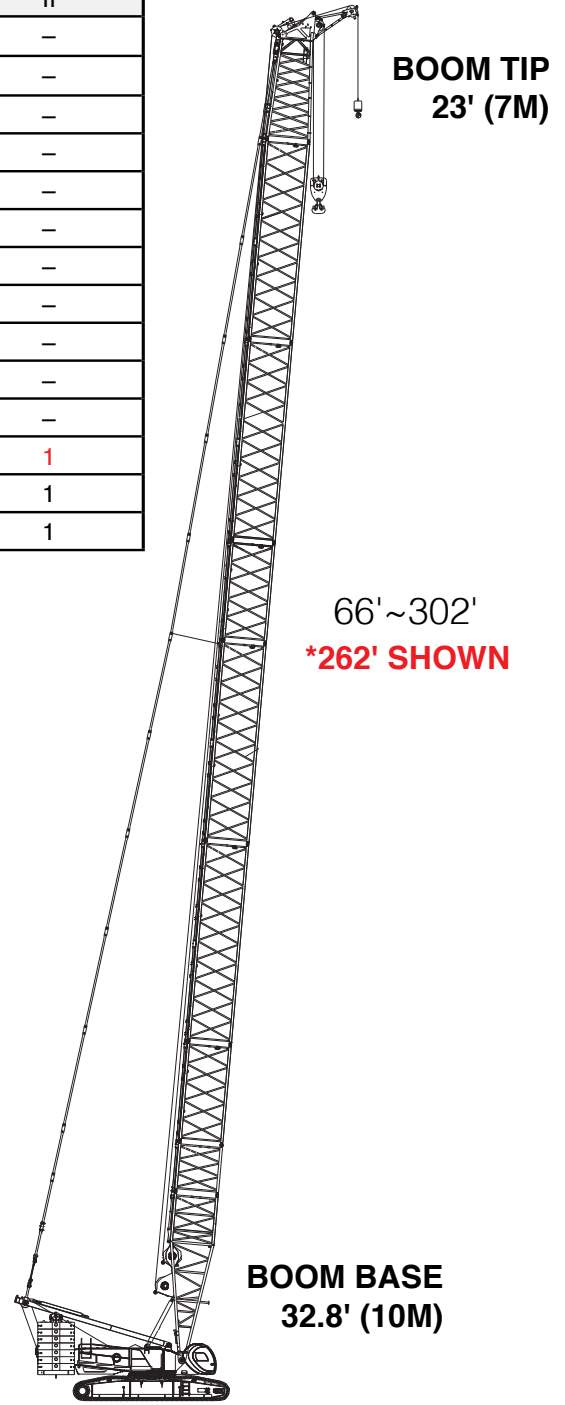



(FJ) FIXED JIB LIGHT LOAD CHART



SCC8300 43 FT FIXED JIB LIGHT									
1412A + 2825A				282,200 lbs + 125,700 lbs		360°			
BOOM ANGLE 10°									
BOOM LENGTH (ft)									
LOAD RAD (ft)	66	85	105	125	144	164	184	203	223
	CAPACITY (Kib)								
30	128.4	131.6							
40	100.3	104.0	112.4	122.7	125.4	127.2	130.1		
50	85.4	89.9	99.8	109.7	115.7	118.4	119.3	119.3	118.1
60	74.3	79.2	88.2	96.4	102.6	105.7	106.4	110.0	110.9
70	64.9	71.0	78.0	85.9	91.2	95.1	97.4	100.4	103.1
80	57.1	64.6	70.9	76.2	81.9	86.0	90.7	92.6	95.4
90	51.0	58.0	64.4	69.5	76.1	80.3	84.7	86.4	89.4
100		52.7	58.7	64.2	69.4	74.3	77.7	80.2	28.0
110			53.8	59.1	64.1	68.7	71.8	75.1	74.4
120			50.0	54.9	59.7	64.0	66.0	68.6	66.0
130				51.1	55.6	59.5	59.3	61.0	58.4
140				48.2	52.3	55.5	54.6	54.3	52.1
150				45.6	49.4	50.6	49.5	48.2	46.5
160					46.2	45.1	44.0	42.7	41.4
170					41.5	40.4	39.3	38.0	36.9
180						36.3	35.2	33.9	32.7
190							31.5	30.2	29.0
200								26.8	25.7
210								23.8	22.7
220								21.1	19.9
230									17.4
BOOM ANGLE 20°									
40	87.3	91.0	94.3						
50	74.2	77.9	82.5	85.7	88.4	90.7	92.5		
60	64.6	69.2	73.4	76.9	79.8	82.5	84.7	86.7	88.5
70	57.2	62.1	66.4	70.0	73.2	75.9	78.3	80.6	82.6
80	51.6	56.5	60.7	64.2	67.5	70.4	73.0	75.2	77.2
90	47.3	51.9	55.9	59.5	62.7	65.6	68.3	70.6	72.9
100		48.0	52.0	55.6	58.7	61.6	64.2	66.6	68.8
110			48.8	52.1	55.2	58.0	60.7	63.1	64.8
120			46.0	49.3	52.2	55.0	57.5	59.7	59.7
130				46.8	49.7	52.3	54.1	55.6	54.6
140				44.8	47.5	49.9	50.9	52.2	50.2
150				45.6	45.5	47.2	47.5	48.0	45.6
160					43.8	44.2	43.8	43.2	41.1
170					42.4	40.8	39.9	38.7	36.9
180						36.7	36.2	34.6	32.7
190							32.2	30.7	29.0
200							28.3	27.2	25.7
210							25.1	24.0	22.5
220								21.2	19.8
230									17.4

BOOM ANGLE 30°									
BOOM LENGTH (ft)									
LOAD RAD (ft)	66	85	105	125	144	164	184	203	223
	CAPACITY (Kib)								
50	63.4	65.9	67.6	69.0					
60	56.6	59.5	61.8	63.8	65.3	66.4	67.5	68.6	69.4
70	51.5	54.6	57.2	59.2	61.1	62.5	63.8	64.9	66.0
80	47.4	50.6	53.3	55.4	57.4	59.1	60.4	61.8	62.7
90	44.2	47.3	50.0	52.3	54.4	55.9	57.6	58.9	60.0
100		44.7	47.2	49.6	51.6	53.4	54.9	56.3	57.6
110			45.1	47.3	49.2	51.0	52.6	54.1	55.4
120				43.1	45.3	47.2	49.0	50.6	52.1
130					43.6	45.4	47.2	48.7	50.0
140					42.4	44.0	45.7	47.2	48.3
150					41.5	42.8	44.3	45.6	46.3
160						41.7	42.9	43.5	43.5
170						41.0	41.1	40.3	39.3
180							36.9	36.2	35.1
190								32.1	31.2
200								28.5	27.6
210								25.4	24.0
220									21.2
230									17.1

*This material is supplied for reference only. Operator must refer to Crane Rating Manual and Operator's Manual to determine allowable crane lifting capacities and assembly operating procedures.



(FJ) FIXED JIB STANDARD LOAD CHART

SCC8300 62 FT FIXED JIB LIGHT										
	1412A + 2825A		282,200 lbs + 125,700 lbs		360°					
BOOM ANGLE 10°										
BOOM LENGTH (ft)										
LOAD RAD (ft)	66	85	105	125	144	164	184	203	223	
CAPACITY (Kib)										
40	80.4	87.5	95.4	102.2						
50	69.5	75.6	82.8	87.2	90.1	92.7	92.2			
60	60.3	65.9	71.0	75.4	79.1	82.1	83.8	83.9	82.1	
70	52.2	57.3	62.0	66.2	69.9	73.7	76.7	77.8	76.4	
80	45.7	50.4	55.0	58.9	62.7	66.3	69.5	72.6	72.1	
90	40.8	45.4	49.5	53.2	57.0	60.3	63.5	66.6	67.8	
100	36.8	41.1	45.0	48.7	52.0	55.3	58.3	61.2	63.8	
110	33.6	37.5	41.3	44.8	48.0	51.1	54.0	56.7	59.5	
120		34.8	38.2	41.5	44.6	47.5	50.3	53.0	55.6	
130			35.6	38.7	41.6	44.5	47.1	49.8	52.2	
140			33.4	36.3	39.1	41.9	44.4	46.9	49.1	
150			31.5	34.2	36.9	39.6	41.9	44.3	45.7	
160				32.4	34.9	37.4	39.6	41.8	41.9	
170				30.7	33.2	35.4	37.8	39.0	37.6	
180					31.7	33.9	36.1	35.0	33.6	
190						32.3	33.0	31.3	30.0	
200						30.3	29.2	27.9	26.6	
210						27.3	26.2	24.9	23.6	
220							23.4	22.2	20.9	
230								19.7	18.5	
240									16.2	
BOOM ANGLE 20°										
50	59.1	61.5								
60	51.2	54.1	56.3	58.4	59.9	61.2	62.6	63.8	64.8	
70	45.3	48.3	50.7	52.9	54.7	56.3	57.8	59.0	60.2	
80	40.7	43.6	46.2	48.4	50.4	52.2	53.7	55.1	56.4	
90	37.0	39.9	42.5	44.7	46.8	48.4	50.2	51.7	53.1	
100	34.0	36.9	39.5	41.7	43.7	45.5	47.2	48.8	50.1	
110	31.6	34.3	36.8	39.0	41.0	42.9	44.5	46.0	47.4	
120		32.2	34.7	36.6	38.8	40.6	42.1	43.7	45.2	
130			32.6	34.8	36.2	38.2	39.8	41.3	43.0	
140			31.1	33.1	34.8	36.6	38.2	39.7	41.1	
150			29.8	31.6	33.4	35.1	36.6	38.1	39.5	
160				30.3	32.1	33.7	35.2	36.6	37.8	
170				29.2	30.7	32.3	33.8	34.9	35.3	
180					29.7	31.3	32.5	32.8	32.2	
190						30.2	30.6	30.2	29.3	
200						29.0	28.3	27.4	26.5	
210						27.6	25.6	24.7	23.8	
220							23.5	22.5	21.4	
230								20.1	19.0	
240									16.6	
250									14.4	
260									12.2	

BOOM ANGLE 30°									
BOOM LENGTH (ft)									
LOAD RAD (ft)	66	85	105	125	144	164	184	203	223
CAPACITY (Kib)									
60	44.4	45.9	47.0	48.0					
70	40.4	41.9	43.3	44.4	45.4	46.1	46.7	47.3	
80	36.9	38.6	40.2	41.4	42.5	43.4	44.2	44.9	45.6
90	34.0	35.9	37.5	39.0	40.1	41.2	42.1	42.8	43.6
100	31.9	33.7	35.4	36.7	38.1	39.2	40.0	40.9	41.6
110	30.1	31.8	33.6	34.9	36.2	37.3	38.4	39.3	40.0
120		30.4	31.9	33.2	34.6	35.7	36.8	37.6	38.5
130			30.6	31.5	32.9	34.2	35.1	36.3	36.8
140			29.4	30.6	31.9	33.1	33.9	35.1	35.9
150				29.7	30.9	32.0	32.9	34.0	34.9
160				28.9	30.0	31.1	32.0	32.9	33.8
170				28.2	29.2	30.1	31.2	32.1	32.9
180					28.5	29.4	30.3	30.7	30.8
190						28.8	28.9	28.8	28.5
200						28.3	27.1	26.6	26.1
210						27.8	24.9	24.5	23.8
220							23.5	22.6	22.0
230								20.3	19.6
240									17.0
250									14.6
260									12.4

*This material is supplied for reference only. Operator must refer to Crane Rating Manual and Operator's Manual to determine allowable crane lifting capacities and assembly operating procedures.



(FJ) FIXED JIB STANDARD LOAD CHART

80 FT FIXED JIB LIGHT



1412A
+
2825A



282,200 lbs
+
125,700 lbs



360°

BOOM ANGLE 10°

BOOM LENGTH (ft)

LOAD RAD (ft)	66	85	105	125	144	164	184	203	223
	CAPACITY (Kib)								
40	75.5	78.9							
50	62.2	64.6	68.8	70.5	70.5				
60	52.7	54.7	59.3	62.4	65.0	66.8	67.7	68.9	68.3
70	45.4	48.5	52.2	55.1	57.7	59.7	61.2	63.8	64.8
80	39.7	43.3	46.6	49.3	52.1	54.0	56.3	58.5	59.9
90	35.5	38.7	41.8	44.6	47.2	49.6	51.8	54.1	55.8
100	31.9	35.2	38.1	40.6	43.1	45.5	47.7	49.8	51.8
110	29.1	32.1	34.9	37.3	39.7	41.9	44.2	46.1	48.1
120	26.7	29.5	32.2	34.6	37.0	39.0	41.2	43.1	45.0
130	23.6	27.3	29.8	32.2	34.5	35.7	37.9	39.7	41.6
140		25.6	27.9	30.2	32.4	34.1	36.0	37.7	39.6
150			26.2	28.4	30.5	32.5	34.2	36.0	37.7
160				26.8	28.7	30.7	32.4	34.1	35.7
170				25.5	27.2	29.0	30.7	32.3	33.8
180				24.3	26.0	27.6	29.2	30.9	32.5
190					24.8	26.4	27.9	29.6	30.3
200					23.7	25.3	26.8	28.0	27.5
210					22.7	24.3	25.8	25.8	24.5
220						23.4	24.1	23.1	21.8
230							22.0	20.7	19.3
240								18.4	17.1
250									16.2
260									14.2
270									11.2

BOOM ANGLE 20°

60	44.4	46.0	47.3	48.5	49.4				
70	38.8	41.1	42.6	44.1	45.2	46.2	47.1	48.0	
80	34.9	37.2	38.8	40.2	41.5	42.8	43.7	44.8	45.5
90	31.8	33.9	35.6	37.2	38.5	39.8	40.8	41.9	42.8
100	29.1	31.1	32.9	34.5	35.9	37.3	38.4	39.5	40.3
110	27.0	29.0	30.7	32.3	33.8	35.0	36.2	37.3	38.2
120	25.3	27.0	28.8	30.3	31.8	33.1	34.3	35.3	36.3
130	22.6	25.5	26.8	28.3	29.8	30.9	32.3	33.3	34.3
140		24.2	25.6	27.0	28.5	29.6	30.9	32.0	32.9
150			24.5	25.8	27.2	28.5	29.7	30.8	31.6
160				24.7	26.0	27.3	28.4	29.5	30.4
170				23.7	25.0	26.1	27.2	28.3	29.4
180					24.0	25.2	26.2	27.3	28.4
190					23.2	24.4	25.3	26.4	27.3
200					22.5	23.5	24.5	25.5	25.8
210					21.8	22.7	23.8	24.5	23.8
220						22.2	23.0	22.8	21.6
230							21.5	20.8	19.6
240								19.7	18.6
250									16.7
260									14.6
270									11.6

BOOM ANGLE 30°

BOOM LENGTH (ft)

LOAD RAD (ft)	66	85	105	125	144	164	184	203	223
	CAPACITY (Kib)								
70	32.2	35.5							
80	29.7	32.5	33.4	34.3	34.8	35.4	35.9	36.3	36.6
90	28.1	30.2	31.3	32.1	32.8	33.4	34.0	34.5	34.9
100	26.5	28.1	29.2	30.1	31.0	31.8	32.3	32.9	33.3
110	25.1	26.5	27.6	28.6	29.5	30.3	30.8	31.5	32.1
120	23.7	25.1	26.2	27.3	28.2	28.8	29.6	30.2	30.8
130		23.9	25.0	26.0	26.9	27.7	28.2	28.9	29.6
140		22.9	24.0	24.9	25.8	26.7	27.3	28.0	28.6
150			23.1	24.0	24.9	25.7	26.4	27.1	27.7
160				23.2	24.1	24.9	25.6	26.3	26.9
170				22.5	23.2	24.1	24.8	25.5	26.1
180				21.9	22.7	23.4	24.1	24.8	25.4
190					22.2	22.8	23.5	24.2	24.7
200					21.7	22.3	23.0	23.6	24.0
210					21.4	21.8	22.5	22.9	23.1
220						21.5	22.0	22.2	21.4
230							21.1	20.6	19.9
240								19.8	18.8
250									17.0
260									14.8
270									11.9

*This material is supplied for reference only. Operator must refer to Crane Rating Manual and Operator's Manual to determine allowable crane lifting capacities and assembly operating procedures.



(FJ) FIXED JIB STANDARD LOAD CHART

100 FT FIXED JIB LIGHT



1412A
+
2825A



282,200 lbs
+
125,700 lbs



360°

BOOM ANGLE 10°

BOOM LENGTH (ft)

LOAD RAD (ft)	66	85	105	125	144	164	184	203	223
	CAPACITY (Kib)								
50	51.9	54.7							
60	44.6	47.6	49.8	51.3	51.8	52.9	54.0	54.0	54.8
70	40.3	43.0	45.0	46.1	47.5	48.3	48.4	50.7	52.3
80	35.8	38.6	40.3	41.9	43.7	44.9	45.1	46.5	48.0
90	32.2	34.7	36.5	38.6	41.1	42.3	42.8	42.6	44.5
100	29.1	31.5	33.3	35.7	37.6	39.1	40.2	39.5	41.3
110	26.6	28.8	30.8	32.8	34.7	36.3	37.4	37.3	38.9
120	24.3	26.5	28.5	30.4	32.2	33.9	35.3	34.8	36.5
130	22.5	24.5	26.5	28.2	29.6	31.6	32.7	32.3	34.2
140	20.8	23.0	24.7	26.5	28.0	29.7	31.1	31.3	32.8
150	15.8	21.5	23.3	24.9	26.5	28.0	29.5	30.3	31.6
160			22.0	23.5	25.1	26.5	27.9	29.2	30.5
170			20.8	22.1	23.7	25.0	26.6	27.9	29.0
180				21.1	22.5	24.0	25.2	26.5	27.6
190					21.5	22.8	24.1	25.3	26.5
200						21.7	23.1	24.2	25.4
210						20.9	22.0	23.1	24.3
220						20.1	21.2	22.3	22.1
230							20.5	20.8	19.8
240							19.6	19.0	17.5
250							18.2	16.9	15.3
260							16.2	14.8	13.5
270								12.9	11.6
280									9.9

BOOM ANGLE 20°

60	37.5								
70	33.4	35.9	36.5	37.1					
80	30.1	32.7	33.8	34.5	35.0	35.3	35.7	35.7	36.0
90	27.6	29.7	31.3	32.1	33.0	33.6	34.2	34.4	34.6
100	25.4	27.4	28.9	30.1	31.1	31.9	32.8	32.8	33.3
110	23.6	25.2	26.8	28.1	29.4	30.4	31.1	31.3	31.9
120	21.8	23.7	25.1	26.3	27.6	28.8	29.5	29.5	30.5
130	20.3	22.2	23.3	24.5	25.6	26.9	27.6	27.6	28.6
140	18.8	21.0	22.1	23.2	24.5	25.6	26.4	26.8	27.7
150		20.0	21.0	22.1	23.4	24.5	25.4	26.0	26.8
160			20.1	21.0	22.3	23.3	24.2	25.1	26.0
170			19.1	20.2	21.3	22.1	23.2	24.1	25.0
180			18.2	19.3	20.4	21.2	22.3	23.1	24.0
190				18.7	19.7	20.4	21.5	22.2	23.1
200					19.0	19.7	20.6	21.3	22.2
210					18.3	19.2	19.8	20.5	21.2
220						18.7	19.2	19.8	20.0
230						18.0	18.5	18.9	18.7
240						17.4	17.8	17.8	17.3
250							17.1	16.4	15.8
260							16.0	15.0	14.1
270								13.2	12.2
280									10.3
290									8.8
300									7.4

BOOM ANGLE 30°

BOOM LENGTH (ft)

LOAD RAD (ft)	66	85	105	125	144	164	184	203	223
	CAPACITY (Kib)								
80	24.7	27.0	28.4						
90	23.0	25.2	26.4	26.3	26.9	27.4			
100	21.6	23.3	24.6	24.7	25.5	26.0	26.0	26.3	26.5
110	20.4	21.8	22.9	23.3	24.2	24.7	24.9	25.3	25.5
120	19.2	20.7	21.6	22.2	23.1	23.5	23.8	24.3	24.5
130	18.0	19.7	20.5	20.9	21.8	22.2	22.7	23.1	23.3
140	17.0	19.0	19.7	20.1	21.0	21.5	21.9	22.5	22.7
150		18.4	18.9	19.3	20.3	20.8	21.2	21.9	22.1
160		18.0	18.1	18.6	19.6	20.1	20.5	21.2	21.5
170		17.4	17.4	18.1	18.8	19.4	19.8	20.5	20.9
180			17.3	17.5	18.3	18.8	19.4	19.7	20.3
190				17.1	17.8	18.2	18.9	19.1	19.7
200					17.4	17.8	18.3	18.6	19.0
210					17.2	17.4	17.6	18.1	18.3
220						17.2	17.3	17.7	18.0
230						17.1	17.1	17.3	17.6
240						16.9	16.8	16.7	17.1
250							16.3	16.0	16.2
260							15.8	15.0	14.7
270								13.5	12.5
280									10.4
290									8.7
300									7.5

*This material is supplied for reference only. Operator must refer to Crane Rating Manual and Operator's Manual to determine allowable crane lifting capacities and assembly operating procedures.



(FJ) FIXED JIB STANDARD LOAD CHART



118 FT FIXED JIB LIGHT										
	1412A + 2825A		282,200 lbs + 125,700 lbs		360°					
BOOM ANGLE 10°										
BOOM LENGTH (ft)										
LOAD RAD (ft)	66	85	105	125	144	164	184	203	223	
	CAPACITY (Kib)									
60	39.2	42.0	43.6	44.4	44.5	43.8				
70	34.9	36.6	38.1	38.9	39.7	40.2	40.4	37.6	37.6	
80	31.3	32.7	34.3	35.8	36.6	37.3	37.6	35.3	35.3	
90	28.5	30.0	31.5	32.9	33.7	34.5	35.3	33.6	33.6	
100	26.1	27.8	29.1	30.7	31.1	31.8	33.1	32.2	31.9	
110	23.9	25.4	27.0	28.5	29.0	29.6	30.6	30.7	30.3	
120	22.4	23.7	25.1	26.3	27.2	27.8	28.2	28.7	28.5	
130	20.1	21.7	23.0	23.9	24.8	25.7	26.0	26.9	26.7	
140	17.8	20.3	22.1	22.9	23.8	24.5	24.9	26.0	25.8	
150	15.7	19.0	21.2	21.8	22.8	23.4	24.0	25.1	24.9	
160			20.0	20.7	21.8	22.5	23.1	24.2	24.1	
170			18.8	19.7	20.8	21.5	22.1	23.2	23.2	
180			17.9	19.0	19.8	20.5	21.1	22.3	22.3	
190				18.3	18.9	19.6	20.3	21.5	21.5	
200					18.0	18.7	19.5	20.7	20.7	
210					17.0	17.6	18.5	20.1	20.1	
220					16.3	16.8	17.8	19.4	19.0	
230						16.2	17.4	18.7	18.1	
240							17.1	17.9	17.0	
250								16.7	15.3	
260								15.0	13.5	
270								13.3	11.7	
280								11.6	10.1	
290									8.4	
300									6.9	
BOOM ANGLE 20°										
80	27.0	27.5	28.3	29.0	29.4	29.7	30.1			
90	24.7	25.4	26.1	27.0	27.4	27.6	28.1	28.4	28.6	
100	22.6	24.0	24.8	25.4	26.1	26.5	27.0	27.4	27.5	
110	20.9	22.3	23.4	24.2	24.9	25.3	25.8	26.4	26.0	
120	19.7	20.9	21.8	22.8	23.5	24.0	24.4	24.9	24.6	
130	17.5	19.4	20.5	21.1	21.8	22.5	22.9	23.6	23.3	
140	15.7	18.5	19.7	20.2	20.9	21.6	21.8	22.7	22.6	
150	14.1	17.6	18.9	19.3	20.0	20.7	21.0	21.9	21.8	
160	12.4	16.8	18.1	18.5	19.2	19.9	20.3	21.2	21.0	
170	10.9	16.1	17.3	17.7	18.4	19.1	19.5	20.4	20.3	
180		15.5	16.6	17.0	17.7	18.4	18.8	19.7	19.7	
190			15.9	16.5	17.0	17.6	18.1	19.0	19.0	
200				15.9	16.2	16.8	17.4	18.3	18.3	
210				15.4	15.4	16.1	16.8	17.6	17.6	
220					15.1	15.6	16.1	17.1	17.0	
230						15.2	15.6	16.6	16.4	
240							15.3	15.9	15.7	
250								14.9	14.7	
260								14.1	13.3	
270								13.0	12.0	
280								11.7	10.5	
290								10.2	8.8	
300								8.8	7.4	
310									6.0	

BOOM ANGLE 30°										
BOOM LENGTH (ft)										
LOAD RAD (ft)	66	85	105	125	144	164	184	203	223	
	CAPACITY (Kib)									
90	20.6	20.7								
100	19.3	19.3	21.6	22.0	22.2	22.3	22.2	22.6		
110	18.0	18.1	20.3	20.5	20.9	21.1	21.7	21.9	21.7	
120	17.1	17.3	18.9	19.4	19.9	20.3	20.7	21.0	21.0	
130	15.4	16.5	18.0	18.4	18.8	19.1	19.6	19.9	19.9	
140	13.9	15.7	17.2	17.6	18.0	18.4	18.7	19.3	19.4	
150	12.5	15.2	16.4	16.8	17.3	17.8	18.0	18.7	18.8	
160	11.2	15.0	15.8	16.2	16.7	17.2	17.5	18.1	18.1	
170	10.0	14.5	15.4	15.7	16.1	16.5	17.0	17.4	17.4	
180			15.1	15.2	15.6	16.1	16.5	17.0	17.0	
190			14.5	14.6	15.0	15.5	16.0	16.5	16.5	
200				14.1	14.5	14.8	15.5	15.9	15.9	
210				13.9	14.1	14.3	15.0	15.2	15.4	
220					13.9	14.1	14.5	14.9	15.1	
230						13.9	14.0	14.1	14.5	14.8
240							13.8	13.8	14.2	14.5
250								13.4	13.9	14.1
260								13.4	13.3	13.4
270								13.4	12.6	12.3
280									11.6	11.0
290									10.4	9.5
300									9.0	7.8
310										6.4

*This material is supplied for reference only. Operator must refer to Crane Rating Manual and Operator's Manual to determine allowable crane lifting capacities and assembly operating procedures.



(FJ) FIXED JIB STANDARD LOAD CHART

138 FT FIXED JIB LIGHT										
	1412A + 2825A		282,200 lbs + 125,700 lbs		360°					
BOOM ANGLE 10°										
BOOM LENGTH (ft)										
LOAD RAD (ft)	66	85	105	125	144	164	184	203	223	
	CAPACITY (Kib)									
60	35.3	35.5	35.2	34.9						
70	31.4	31.4	32.0	33.0	32.0	31.5	31.5			
80	27.8	28.1	29.0	30.5	29.0	28.8	28.8	28.5	27.6	
90	24.8	26.0	26.9	27.5	26.7	26.5	26.9	26.8	26.6	
100	22.9	24.4	25.3	25.4	24.8	24.8	25.3	25.6	25.4	
110	21.5	22.8	23.2	23.1	23.0	23.3	23.8	24.2	24.4	
120	19.3	20.5	21.2	21.2	21.3	21.8	22.2	22.9	23.4	
130	17.3	18.2	19.0	19.4	19.6	20.1	20.7	21.6	22.2	
140	15.1	17.0	18.0	18.3	18.8	19.3	19.8	20.8	21.6	
150	13.1	15.8	17.0	17.3	17.9	18.5	18.9	20.0	21.0	
160	11.3	14.5	16.1	16.3	17.0	17.7	18.1	19.2	20.3	
170	9.6	13.3	15.1	15.5	16.3	17.0	17.4	18.5	19.6	
180		12.6	14.1	14.5	15.4	16.1	16.6	17.9	19.0	
190			13.2	13.7	14.4	15.0	15.9	17.3	18.4	
200			12.4	13.1	13.4	14.0	15.2	16.8	17.9	
210			11.9	12.6	12.6	13.2	14.6	16.3	17.2	
220				12.1	11.9	12.4	13.9	15.5	16.2	
230					11.2	11.8	13.4	14.5	15.1	
240						11.4	13.1	13.6	13.9	
250							12.8	12.9	12.9	
260							12.2	11.9	11.9	
270								11.1	11.1	
280									10.3	
BOOM ANGLE 20°										
80	25.2	25.8								
90	22.5	22.9	23.2	23.6	24.0	24.3				
100	20.2	21.1	21.5	21.8	22.1	22.4	22.8	23.2	23.2	
110	18.4	19.6	20.2	20.5	20.1	20.9	21.5	21.8	22.0	
120	16.5	18.2	18.7	19.1	18.7	19.3	20.2	20.4	20.9	
130	14.4	16.5	17.0	17.6	17.4	18.0	18.9	19.3	19.6	
140	12.8	15.6	16.2	16.7	16.7	17.4	18.0	18.6	18.9	
150	11.2	14.6	15.5	15.9	16.2	16.8	17.3	17.9	18.4	
160	9.6	13.7	14.8	15.2	15.5	16.1	16.7	17.3	17.7	
170	8.5	12.9	14.1	14.6	14.8	15.4	16.1	16.8	17.0	
180	7.1	12.0	13.5	14.0	14.2	14.6	15.5	16.2	16.4	
190		11.2	12.8	13.3	13.5	13.9	14.9	15.7	15.8	
200			12.2	12.7	12.8	13.2	14.4	15.3	15.2	
210			11.9	12.3	12.3	12.6	13.7	14.8	14.6	
220				12.0	11.8	12.1	13.2	14.1	13.9	
230					11.4	11.7	12.8	13.4	13.2	
240					11.1	11.4	12.5	12.8	12.5	
250						11.2	12.3	12.3	11.9	
260						10.9	12.0	11.7	11.2	
270							11.5	11.1	10.5	
280								10.7	9.8	
290								9.4	9.3	
300								1.4	8.9	

BOOM ANGLE 30°									
BOOM LENGTH (ft)									
LOAD RAD (ft)	66	85	105	125	144	164	184	203	223
	CAPACITY (Kib)								
100	17.6	18.5							
110	15.7	17.4	17.6	18.2	17.4				
120	14.0	16.1	16.5	16.9	16.1	17.0	18.1	18.0	18.5
130	12.3	15.1	15.2	15.6	15.1	16.0	16.9	16.9	17.2
140	11.0	14.3	14.5	15.0	14.7	15.4	16.3	16.3	16.4
150	9.6	13.6	14.0	14.5	14.4	14.9	15.8	15.8	15.7
160	8.4	13.0	13.6	14.0	14.0	14.5	15.3	15.3	15.1
170	7.4	12.2	13.2	13.4	13.4	13.9	14.8	14.8	14.6
180	6.2	11.2	12.8	13.0	13.0	13.4	14.3	14.3	14.0
190		10.2	12.4	12.6	12.5	12.9	13.8	13.9	13.3
200		9.3	12.1	12.3	12.1	12.4	13.3	13.5	12.6
210		8.6	11.9	12.1	11.9	11.9	12.8	13.0	11.9
220			11.7	12.1	11.9	11.7	12.4	12.7	11.6
230				12.0	11.8	11.6	12.1	12.3	11.3
240					11.6	11.5	11.8	12.0	11.1
250						11.5	11.7	11.7	11.0
260						11.3	11.5	11.3	10.5
270							11.5	11.0	10.0
280								10.7	9.5
290								10.4	8.9
300								10.0	8.5
310								9.5	8.0
320									7.1

*This material is supplied for reference only. Operator must refer to Crane Rating Manual and Operator's Manual to determine allowable crane lifting capacities and assembly operating procedures.

STANDARD FIXED JIB ATTACHMENT ON (H) WORKING RANGE DIAGRAM

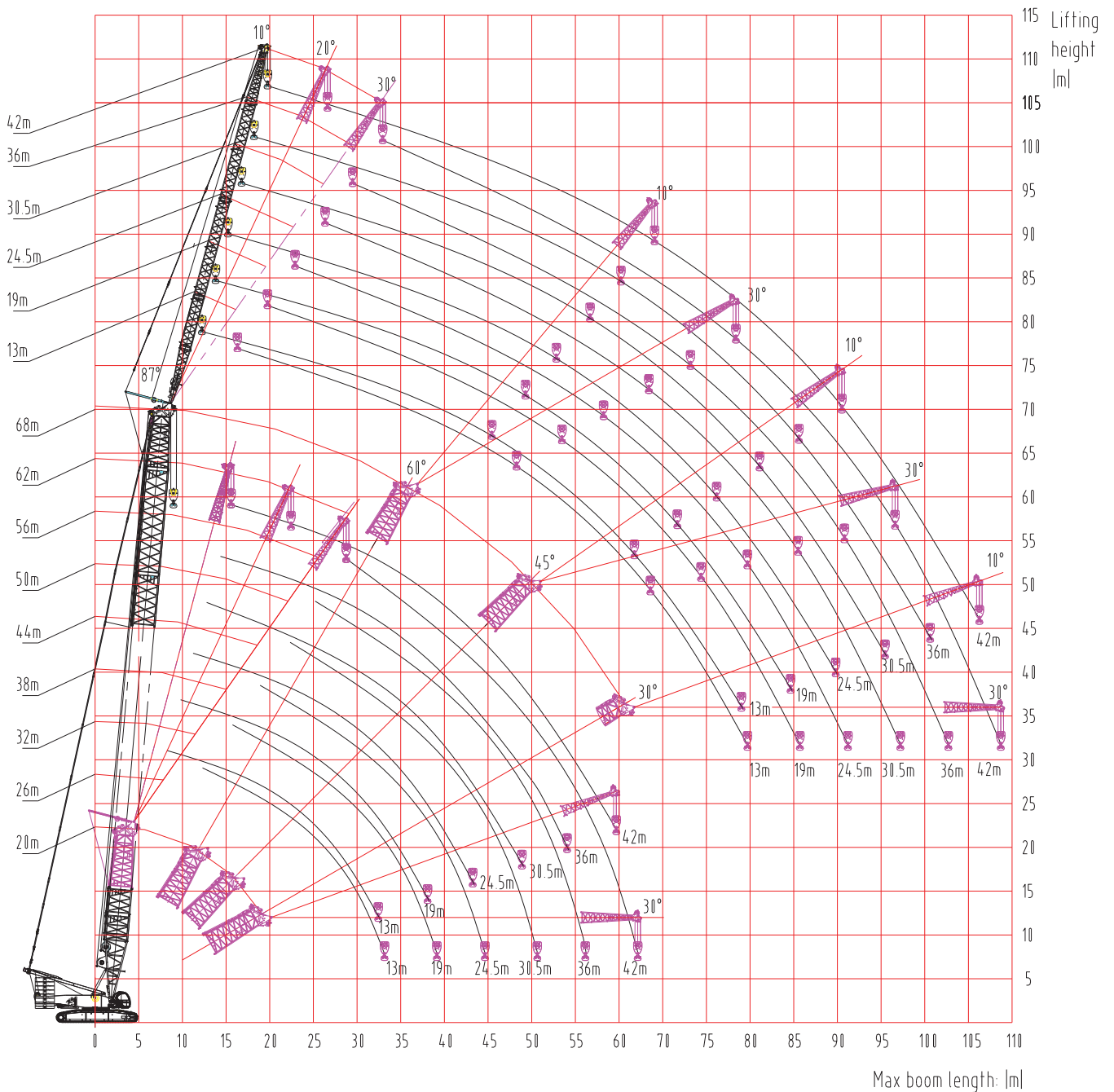

FIXED JIB STANDARD OPERATING CONDITIONS

1412A - FJ Configuration		
Fixed Jib Length (ft)	Jib Sections	
	19'8" 1412A Insert	37'9" 1412A Insert
42.7'	-	-
62.3'	1	-
80.4'	-	1
100.1'	1	1
118.1'	-	2
137.8'	1	2

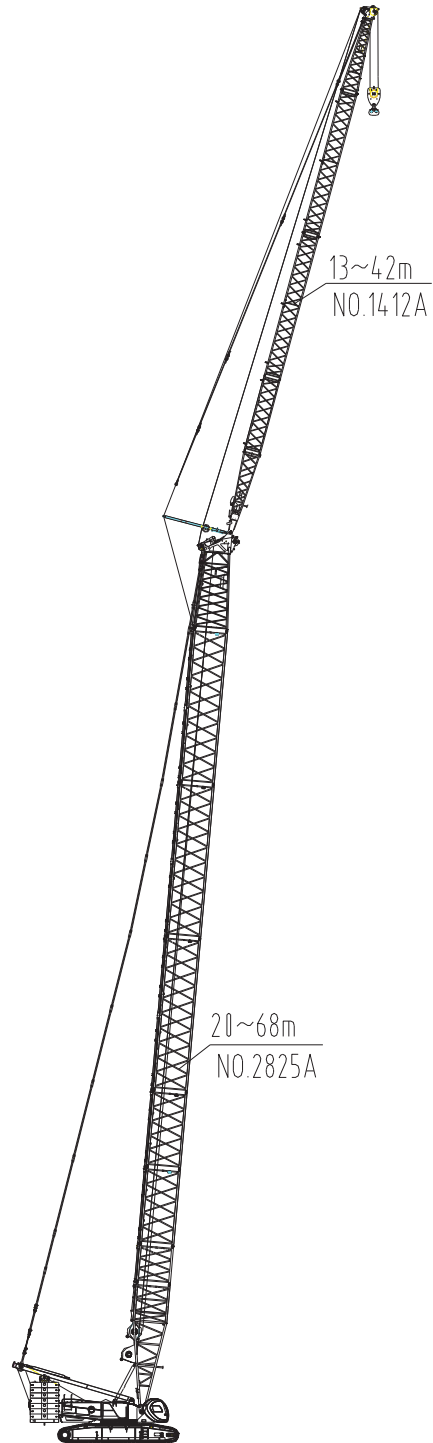

FJ Operating Condition
Max boom length: 110m



(FJH) FIXED JIB HEAVY LOAD CHART

SCC8300 39 FT FIXED JIB HEAVY



2316A
+
2825A



282,200 lbs
+
125,700 lbs



360°

BOOM ANGLE 10°

BOOM LENGTH (ft)

LOAD RAD (ft)	66	85	105	125	144	164	184	203	223	243
	CAPACITY (Kib)									
30	180.8	215.2	218.4	218.7	218.4	218.0	217.8			
40	151.4	167.5	179.9	190.6	199.5	216.7	214.6	192.5	153.1	109.0
50	124.0	137.8	149.8	160.0	169.1	177.8	185.4	186.6	148.3	105.2
60	104.0	116.4	127.6	138.0	147.0	155.1	162.7	160.6	143.0	103.7
70	89.9	101.5	111.8	121.2	130.2	138.3	139.5	135.0	130.5	102.5
80	78.9	89.6	99.4	108.4	116.9	122.9	119.1	114.9	111.2	101.0
90	70.7	80.6	89.7	98.4	106.1	106.5	103.0	99.3	95.9	94.0
100		73.3	81.6	89.6	94.5	92.8	89.9	86.6	83.4	81.9
110		67.3	75.2	82.5	82.0	80.8	79.0	76.0	73.2	71.8
120			69.9	72.9	71.9	70.8	69.7	67.1	64.4	63.3
130				64.5	63.5	62.3	61.2	59.5	56.8	56.1
140					56.4	55.2	54.1	52.7	50.5	49.9
150					50.2	49.0	47.9	46.6	44.8	44.4
160						43.7	42.5	41.2	39.8	39.5
170						38.9	37.8	36.5	35.4	35.1
180							33.7	32.4	31.2	31.4
190								28.5	27.4	27.9
200									24.0	24.6
210									21.2	21.8
220										19.1

BOOM ANGLE 15°

30	157.3	177.1	182.6	186.8						
40	134.7	144.0	151.6	157.7	162.9	167.4	170.8	174.2	147.2	106.0
50	112.3	121.6	129.7	136.8	142.5	147.7	152.1	156.4	144.8	105.2
60	96.0	105.3	113.7	120.7	126.9	132.2	137.4	141.5	142.5	104.0
70	84.1	93.2	101.3	108.2	114.5	120.1	125.2	129.6	130.8	102.8
80	74.9	83.7	91.3	98.1	104.3	109.8	114.9	116.2	112.3	102.0
90	68.0	76.1	83.4	90.0	96.0	101.4	103.9	100.5	97.1	95.0
100		69.9	76.9	83.2	88.9	93.6	90.7	87.5	84.4	83.0
110		64.9	71.3	77.3	82.0	81.6	79.8	76.7	74.0	72.7
120			66.9	72.1	72.6	71.3	70.4	67.8	65.1	64.2
130				64.7	63.8	62.7	61.8	60.1	57.6	56.8
140					56.7	55.6	54.5	53.3	51.2	50.5
150					50.4	49.3	48.2	47.1	45.3	44.8
160						43.9	42.8	41.7	40.2	40.0
170						39.1	38.2	36.9	35.8	35.6
180							33.9	32.7	31.5	31.8
190								29.0	27.7	28.1
200								25.5	24.4	24.9
210									21.4	22.0
220										19.3

BOOM ANGLE 20°



BOOM LENGTH (ft)

LOAD RAD (ft)	66	85	105	125	144	164	184	203	223	243
	CAPACITY (Kib)									
30	139.0									
40	120.7	126.5	131.0	134.8	138.0	140.9	142.5	144.9	140.7	105.2
50	102.4	109.4	114.8	119.5	123.5	126.9	129.7	132.1	134.1	104.7
60	89.2	96.4	102.4	107.5	112.0	115.7	119.0	121.8	124.6	104.1
70	79.3	86.6	92.5	97.8	102.4	106.3	110.0	113.1	116.0	103.4
80	71.5	78.5	84.6	89.9	94.6	98.5	102.3	105.6	108.4	102.9
90	65.6	72.3	78.1	83.4	88.0	92.0	96.0	99.3	98.2	96.1
100		67.0	72.6	77.7	82.3	86.5	89.9	88.4	85.3	83.8
110		63.0	68.1	73.0	77.4	81.3	80.5	77.6	74.7	73.6
120			64.4	69.0	72.5	71.9	70.8	68.5	66.0	64.9
130				64.8	64.3	63.2	62.3	60.6	58.2	57.5
140					56.9	55.9	54.9	53.8	51.6	51.2
150					50.6	49.7	48.6	47.5	45.9	45.5
160						44.1	43.2	41.9	40.7	40.5
170						39.3	38.4	37.1	36.0	36.0
180							34.1	33.0	31.9	32.0
190								29.2	28.1	28.5
200								25.7	24.6	25.3
210									21.6	22.3
220										19.5

*This material is supplied for reference only. Operator must refer to Crane Rating Manual and Operator's Manual to determine allowable crane lifting capacities and assembly operating procedures.

(FJH) FIXED JIB HEAVY LOAD CHART

SCC8300 59 FT FIXED JIB HEAVY

 2316A + 2825A		282,200 lbs + 125,700 lbs	 360°
---	---	---------------------------------	--

BOOM ANGLE 10°

BOOM LENGTH (ft)										
LOAD RAD (ft)	66	85	105	125	144	164	184	203	223	243
	CAPACITY (Kib)									
30	148.0	165.1								
40	120.8	128.9	135.8	142.0	146.7	151.6	155.8	156.7	127.3	100.7
50	97.5	105.3	112.6	118.9	124.5	129.7	134.0	138.0	126.5	98.7
60	81.6	89.4	96.2	102.4	108.1	113.0	118.1	121.8	124.9	97.0
70	70.3	77.5	84.1	90.2	95.6	100.7	105.3	109.5	113.5	95.2
80	61.7	68.5	74.6	80.4	85.8	90.4	95.2	99.2	103.3	93.3
90	55.2	61.6	67.2	72.8	77.7	82.3	86.8	91.0	94.8	91.6
100	49.8	55.9	61.3	66.3	71.2	75.6	79.9	83.7	83.6	81.9
110	45.6	51.2	56.3	61.1	65.6	70.0	74.0	76.3	73.5	71.9
120		47.2	52.0	56.6	61.0	65.1	69.0	67.5	64.9	63.8
130			48.5	52.9	56.9	60.9	62.6	60.0	57.5	56.6
140				49.6	53.3	56.6	55.5	53.6	51.2	50.3
150				46.6	50.3	50.5	49.3	47.9	45.5	44.8
160					46.3	51.6	43.9	42.6	40.6	40.0
170					41.7	40.4	39.3	38.0	36.2	35.7
180						36.2	35.0	33.7	32.3	31.9
190							31.4	30.1	28.8	28.3
200							27.9	26.6	25.4	25.3
210								23.6	22.3	22.5
220									19.5	19.8
230										17.3
240										15.2

BOOM ANGLE 15°

30										
40	105.7	110.2	114.2	117.2	119.6	121.5	123.5			
50	87.7	93.0	97.5	101.3	104.5	107.2	110.0	112.1	114.1	98.8
60	74.9	80.5	85.3	89.3	92.8	96.1	98.8	101.4	103.9	97.3
70	65.5	71.0	75.7	80.1	83.8	87.1	90.2	92.9	95.5	95.9
80	58.3	63.6	68.3	72.5	76.1	79.6	82.8	85.6	88.0	90.7
90	52.6	57.7	62.3	66.4	70.1	73.4	76.6	79.6	82.1	84.7
100	47.9	52.9	57.1	61.4	64.9	68.2	71.3	74.2	76.6	79.4
110	44.2	48.9	53.1	57.1	59.4	63.7	66.8	69.6	72.1	73.1
120		45.5	49.5	53.2	55.8	59.8	62.8	65.7	66.0	64.9
130			46.5	50.0	52.2	56.2	59.3	60.9	58.6	57.5
140			43.8	47.2	48.2	53.4	55.7	54.5	52.1	51.2
150				44.7	45.2	50.7	50.0	48.6	46.4	45.7
160					45.5	45.7	44.6	43.2	41.3	40.8
170					42.0	40.9	39.8	38.4	36.9	36.5
180						36.6	35.5	34.3	32.9	32.5
190						32.7	31.6	30.5	29.2	29.0
200							28.2	27.0	25.8	25.7
210								24.0	22.7	22.9
220									20.0	20.2
230									17.3	17.8
240										15.4

BOOM ANGLE 20°

BOOM LENGTH (ft)										
LOAD RAD (ft)	66	85	105	125	144	164	184	203	223	243
	CAPACITY (Kib)									
30										
40	94.7	96.5	98.6							
50	79.8	83.2	86.1	88.5	90.4	92.0	93.5	94.8	95.1	
60	68.9	72.9	76.7	79.5	81.8	83.8	85.6	87.1	87.9	86.9
70	60.9	65.2	69.2	72.0	74.8	77.1	79.1	80.9	82.0	80.8
80	54.6	58.8	62.9	66.1	68.8	71.3	73.5	75.5	76.5	75.5
90	49.6	53.8	58.0	61.1	64.0	66.5	68.8	70.9	70.6	69.4
100	45.5	49.4	53.8	56.9	59.8	62.2	64.6	66.6	66.3	65.6
110	42.2	45.9	50.1	53.4	56.1	58.7	60.9	62.4	61.8	60.3
120		42.9	47.1	50.3	53.0	55.5	57.8	59.3	58.5	57.0
130		40.4	44.6	47.5	50.3	52.8	55.0	56.8	54.3	52.6
140			42.6	45.2	47.9	50.2	52.6	53.9	52.9	52.1
150				43.2	45.8	48.0	50.2	49.4	47.2	46.6
160					43.9	45.6	45.0	43.9	42.0	41.6
170					42.2	41.3	40.2	39.1	37.6	37.1
180						37.0	35.9	34.8	33.5	33.1
190						32.9	32.1	31.0	29.6	29.4
200							28.7	27.3	26.2	26.2
210								24.3	23.1	23.4
220								21.4	20.2	20.6
230									17.8	18.0
240										15.8

*This material is supplied for reference only. Operator must refer to Crane Rating Manual and Operator's Manual to determine allowable crane lifting capacities and assembly operating procedures.



RANGE DIAGRAM UNDER DEVELOPMENT





FIXED JIB HEAVY OPERATING CONDITIONS

2316A Boom - FJH Configuration	
Fixed Jib Length (ft)	
	19.8' 2316A Center
39'	-
59'	1

DRAWING
UNDER
DEVELOPMENT



(LJ) LUFFING JIB LOAD CHART

SCC8300 59 FT LUFFING JIB									
	2316A + 2825A		282,200 lbs + 125,700 lbs		360°				
BOOM ANGLE 87°									
BOOM LENGTH (ft)									
LOAD RAD (ft)	66	85	105	125	144	164	184	203	
CAPACITY (Kib)									
30	238.1	286.6	300.4						
35	203.2	266.2	258.9	257.8	249.9	235.0	222.2	204.2	
40	163.4	217.2	231.3	239.0	224.9	212.1	194.2	177.2	
45	140.2	193.5	217.2	215.4	204.9	193.8	177.9	163.6	
50	120.5	171.6	203.3	186.3	185.8	178.1	165.1	152.6	
55		151.5	189.0	160.8	170.2	163.3	154.0	142.9	
60								134.1	
65								126.0	
BOOM ANGLE 83°									
40	219.6	264.0	241.8						
45	195.9	237.6	226.9						
50	169.1	208.3	211.5	227.1	211.6				
55	144.5	180.4	190.3	197.8	193.1	174.4	166.0		
60		155.9	164.6	174.8	177.2	160.8	153.2		
65		137.6	144.4	154.4	163.6	149.1	142.4		
45					145.5	139.3	133.2		
50									
55								154.9	
60								142.5	
65								132.8	
70								123.1	
75								113.1	

BOOM ANGLE 75°								
BOOM LENGTH (ft)								
LOAD RAD (ft)	66	85	105	125	144	164	184	203
CAPACITY (Kib)								
55	193.6							
60	172.9	177.0						
65	151.4	163.1						
45	134.9	149.8						
50								
55								
60								
65								
70			146.0					
75			133.6	129.6	122.8			
80				121.0	115.0	108.3		
85				112.3	108.2	102.0		
90					102.3	96.5	90.4	
95							85.6	84.5
100								80.1
105								76.1
BOOM ANGLE 65°								
BOOM LENGTH (ft)								
LOAD RAD (ft)	66	85	105	125	144	164	184	203
CAPACITY (Kib)								
75	127.7							
80								
85								
90								
95			95.3					
100				83.8	47.2			
105				80.5	76.3			
85					72.1			
90								
100								
110								
120						60.3		
125							52.4	
135								42.5

*This material is supplied for reference only. Operator must refer to Crane Rating Manual and Operator's Manual to determine allowable crane lifting capacities and assembly operating procedures.



(LJ) LUFFING JIB LOAD CHART

SCC8300 98 FT LUFFING JIB								
	2316A + 2825A		282,200 lbs + 125,700 lbs		360°			
BOOM ANGLE 87°								
BOOM LENGTH (ft)								
LOAD RAD (ft)	66	85	105	125	144	164	184	203
CAPACITY (Kib)								
40	200.2	231.0	227.9	215.3				
45	167.3	202.4	217.9	205.3	190.9	197.7	167.4	
50	143.6	175.6	202.9	183.7	178.1	167.7	157.6	141.5
55	125.4	153.3	188.5	161.4	163.0	155.6	147.5	133.7
60	111.5	136.0	175.5	141.8	146.1	144.2	137.5	126.3
65	100.7	122.1	161.9	127.2	130.2	132.8	128.5	120.0
70	92.3	111.0	150.9	115.3	117.6	120.2	120.1	113.6
75	84.8	101.5	139.9	105.1	107.0	109.1	110.5	107.6
80	77.9	93.4	128.3	96.4	98.2	99.9	100.8	101.4
85	71.6	86.6	115.4	89.2	90.7	92.0	93.4	93.8
90	66.8	80.9	100.5	83.2	84.4	85.5	86.9	88.0
95							81.0	82.2
BOOM ANGLE 83°								
50	166.2							
55	141.2	179.8	183.3	177.5				
60	120.8	155.5	162.2	163.4	165.6	149.3	142.4	
65	104.5	137.9	143.6	151.3	153.2	138.6	132.4	
70	92.5	124.2	129.0	137.3	142.7	129.6	123.9	110.3
75	82.9	112.8	116.7	123.8	130.3	121.4	116.1	102.5
80	74.9	103.2	106.5	111.8	117.1	114.0	109.1	95.1
85	67.1	94.9	97.9	102.0	106.4	107.5	102.9	88.4
90	62.0	88.1	90.7	94.5	98.3	101.5	97.5	80.6
95		81.9	84.4	87.7	91.0	94.5	92.5	74.8
100					84.6	87.4	88.0	70.2
105					78.9	81.4	83.8	65.7
110						78.5	81.9	61.9

BOOM ANGLE 75°								
BOOM LENGTH (ft)								
LOAD RAD (ft)	66	85	105	125	144	164	184	203
CAPACITY (Kib)								
75	117.7	131.2						
80	102.9	122.6	119.8					
85	93.2	114.0	112.6					
90	83.3	106.0	105.4	100.5				
95	76.5	98.0	98.7	95.2	89.7			
100	71.5	90.5	92.7	90.2	85.1	80.1	74.9	
105	66.1	84.0	87.3	85.5	80.9	76.1	71.2	70.1
110		78.5	82.5	81.0	77.0	72.5	67.8	66.7
115				76.8	73.5	69.2	64.7	63.6
120					70.3	66.1	61.8	60.7
125						63.1	59.1	58.0
130						60.6	56.6	55.5
135								53.2
BOOM ANGLE 65°								
BOOM LENGTH (ft)								
LOAD RAD (ft)	66	85	105	125	144	164	184	203
CAPACITY (Kib)								
100	84.2							
105	77.4	85.1						
110		80.0						
115		75.8	72.6					
120		71.9	68.8	65.1				
125			65.3	61.7				
135				58.7	52.5			
140				55.8	50.1	45.9		
145					47.8	44.1	39.3	
150					45.6	42.2	37.6	
155						40.4	36.2	31.5
160							34.7	30.2
165								28.9
170								27.7

*This material is supplied for reference only. Operator must refer to Crane Rating Manual and Operator's Manual to determine allowable crane lifting capacities and assembly operating procedures.

(LJ) LUFFING JIB LOAD CHART



SCC8300 138 FT LUFFING JIB								
	2316A + 2825A		282,200 lbs + 125,700 lbs		360°			
BOOM ANGLE 87°								
BOOM LENGTH (ft)								
LOAD RAD (ft)	66	85	105	125	144	164	184	203
CAPACITY (Kib)								
50	111.8	165.6	165.5	158.2	148.9			
55	99.9	152.6	164.6	152.9	147.2	136.9	125.0	111.9
60	89.7	135.3	160.9	141.1	142.7	134.4	120.3	107.6
65	78.9	121.6	151.7	126.5	129.5	126.8	116.5	104.2
70	69.5	110.5	142.2	115.1	117.6	118.4	111.4	100.0
75	63.2	101.1	133.2	105.1	107.0	109.1	106.5	96.1
80	58.8	93.3	124.9	196.4	98.0	99.9	101.0	92.4
85	53.4	86.8	117.5	89.0	90.6	92.0	93.1	88.3
90	49.5	81.2	109.6	83.3	84.4	85.7	86.5	83.3
95	46.4	76.1	100.9	78.0	78.8	80.1	80.4	78.3
100	43.9	71.5	92.4	73.3	73.8	75.0	75.2	73.7
105	41.9	67.5	84.7	69.0	69.4	70.5	71.2	69.7
110	39.5	63.7	77.0	65.3	65.6	66.8	67.0	65.2
115	37.2	59.3	69.9	62.0	62.4	63.4	63.6	61.4
120	35.0	53.9	62.2	58.9	59.5	60.1	60.6	57.8
125						57.1	57.8	54.3
130						54.6	55.1	50.8
BOOM ANGLE 83°								
LOAD RAD (ft)	66	85	105	125	144	164	184	203
CAPACITY (Kib)								
60	116.3	155.1						
65	102.5	137.5						
70	89.6	123.7	127.0	131.9	129.2			
75	78.2	112.1	114.6	121.8	118.3	113.3	108.2	99.3
80	68.9	102.4	104.4	111.3	111.0	106.4	101.7	92.0
85	63.0	94.4	96.4	101.6	104.7	100.3	96.0	87.2
90	57.4	87.5	89.3	94.0	97.4	94.8	90.8	81.7
95	52.8	81.8	83.0	87.1	90.5	89.8	86.1	77.2
100	48.8	77.0	77.1	81.2	84.1	85.3	81.8	72.7
105	45.2	72.3	70.8	76.5	78.3	81.1	77.8	67.0
110	43.4	68.2	66.2	71.9	74.1	76.4	74.3	63.8
115	41.6	64.6	61.9	67.6	69.7	72.0	70.9	60.5
120	40.1	61.2	58.1	63.9	65.8	68.0	67.7	57.4
125	38.6	58.1	55.0	61.1	62.6	64.2	64.8	54.7
130	36.1	53.2	53.7	58.2	59.6	61.0	62.1	51.6
135				55.5	56.7	58.0	59.4	49.3
140							56.7	47.1

BOOM ANGLE 75°									
BOOM LENGTH (ft)									
LOAD RAD (ft)	66	85	105	125	144	164	184	203	
CAPACITY (Kib)									
90	77.3								
95	70.0	95.8							
100	64.2	89.8	88.7	83.9					
105	58.2	83.3	84.2	79.6	75.0				
110	54.5	78.1	80.1	75.7	71.4				
115	50.4	73.5	76.4	72.2	68.0	63.6			
120	46.7	69.3	72.7	68.9	64.8	60.7	56.6	55.8	
125	43.8	65.5	68.9	65.9	62.0	58.0	54.1	53.3	
130	41.9	62.4	64.7	63.1	59.3	55.5	51.7	50.3	
135	40.1	59.5	61.6	60.4	56.9	53.2	49.5	48.6	
140		56.6	58.7	57.7	54.6	51.1	47.4	46.5	
145				55.0	52.5	49.0	45.4	44.6	
150				52.5	50.4	47.0	43.7	42.8	
155					48.4	45.2	42.0	41.1	
160						43.5	40.4	39.5	
165							38.9	37.8	
170							37.5	36.6	
BOOM ANGLE 65°									
BOOM LENGTH (ft)									
LOAD RAD (ft)	66	85	105	125	144	164	184	203	
CAPACITY (Kib)									
120	52.0								
125	46.7	66.6							
135	42.1	63.4	56.3						
140	38.6	60.7	53.6						
145	35.9	58.2	51.1	48.0					
150	34.0	55.7	48.7	45.8					
155	31.9	53.2	46.6	43.8	40.5				
160		50.9	44.6	41.8	38.9	34.6			
165		50.0	43.0	40.0	37.2	33.2	29.1		
170				38.3	35.7	31.9	27.9		
175					34.2	30.7	26.7		
180						32.7	29.6	25.6	21.4
185						31.9	28.4	24.6	20.5
190							27.4	23.7	19.7
195									18.8
200									18.1
205									17.3
210									16.5

*This material is supplied for reference only. Operator must refer to Crane Rating Manual and Operator's Manual to determine allowable crane lifting capacities and assembly operating procedures.





(LJ) LUFFING JIB LOAD CHART

SCC8300 177 FT LUFFING JIB								
 2316A + 2825A		 282,200 lbs + 125,700 lbs		 360°				
BOOM ANGLE 87°								
BOOM LENGTH (ft)								
LOAD RAD (ft)	66	85	105	125	144	164	184	203
CAPACITY (Kib)								
55	100.5							
60	86.6	116.2	112.5	107.6	102.0			
65	76.6	115.4	111.7	106.8	101.3		89.8	83.9
70	67.6	108.2	111.0	106.1	100.5	94.5	88.8	82.0
75	61.2	100.3	110.2	102.3	99.5	92.9	86.7	79.3
80	56.3	92.9	108.9	95.8	97.0	90.4	83.5	76.2
85	50.6	86.4	106.2	88.6	89.9	86.8	80.0	73.4
90	46.7	80.7	100.4	82.9	83.9	83.2	76.5	70.1
95	43.9	75.4	94.6	77.6	78.2	79.4	73.1	66.8
100	41.7	70.9	88.9	72.8	73.0	75.3	69.7	63.6
105	39.0	67.2	82.9	68.6	68.3	70.8	66.4	60.4
110	36.8	63.5	77.3	65.0	64.9	66.9	62.9	57.3
115	34.9	60.5	71.9	61.7	61.8	63.1	59.7	54.3
120	33.3	57.9	66.6	58.8	59.1	59.8	56.8	51.6
125	32.1	55.0	61.4	56.2	56.6	57.2	54.0	49.0
130	30.2	50.8	57.1	53.7	54.2	54.8	51.2	45.2
135	29.0	46.5	52.5	51.5	51.9	52.3	48.5	43.3
140	27.8	42.0	48.1	49.4	49.3	49.5	45.9	41.5
145	26.4	37.2	43.7	47.1	46.4	46.6	43.4	39.4
150	25.1	33.3	39.0	43.2	45.6	45.4	41.2	38.1
155	21.9	29.3	34.6	38.8	41.9	43.2	39.0	37.0
160					37.5	39.6	36.8	36.1
BOOM ANGLE 83°								
70	90.0							
75	79.7	109.9	108.7	107.2				
80	69.6	101.7	102.7	105.6	101.0	96.2		
85	64.0	93.8	95.1	100.8	97.4	95.9		
90	57.6	86.7	88.3	93.5	92.4	88.4	84.5	73.3
95	52.3	81.1	82.2	86.5	87.4	83.6	80.1	70.3
100	47.9	76.5	76.3	80.5	82.5	80.8	76.0	67.0
105	43.9	71.9	70.1	75.8	77.2	77.6	72.1	64.2
110	41.5	68.1	65.6	71.3	73.0	73.9	68.7	61.8
115	39.3	64.6	61.2	67.1	68.9	70.6	65.6	59.4
120	37.3	61.3	57.3	63.4	65.2	67.2	62.6	56.6
125	35.6	58.4	54.1	60.4	62.2	63.5	59.8	53.5
130	33.7	55.7	53.1	57.7	58.6	61.0	57.3	51.1
135	31.3	53.3	50.5	55.3	55.5	58.1	54.9	48.5
140	28.8	50.7	47.6	53.0	53.1	55.4	52.6	45.9
145	26.8	47.5	45.1	50.9	51.5	53.1	50.5	43.5
150	25.6	42.6	42.6	48.9	49.3	50.3	48.6	41.5
155	24.4	38.0	41.9	47.0	47.7	48.3	46.8	39.7
160	22.8	33.7	40.1	44.9	46.0	46.6	45.1	37.9
165				42.1	44.0	45.1	43.4	36.0
170				37.4	41.7	43.4	41.6	34.2
175						40.1	40.3	32.7

BOOM ANGLE 75°								
BOOM LENGTH (ft)								
LOAD RAD (ft)	66	85	105	125	144	164	184	203
CAPACITY (Kib)								
100	67.3							
105	61.9	80.2						
110	57.4	76.4						
115	52.4	72.6	70.9					
120	47.7	68.8	67.6	63.6	59.7			
125	43.7	64.8	64.4	60.6	57.2	53.0		
130	40.1	62.0	61.5	57.9	55.0	50.6		
135	37.8	58.9	58.9	55.5	52.9	48.4	44.5	
140	35.9	55.9	56.5	53.2	50.6	46.3	42.6	42.0
145	33.8	53.4	54.2	50.9	47.9	44.3	40.8	40.1
150	32.3	51.4	51.8	48.9	45.8	42.4	39.1	38.2
155	30.3	49.6	49.5	47.0	43.9	40.7	37.6	36.7
160	28.4	47.8	47.3	45.2	42.2	39.1	36.0	35.2
165	26.5	45.8	45.2	43.4	40.5	37.6	34.5	33.7
170	24.5	43.3	43.2	41.6	39.0	36.1	33.3	32.4
175		38.9	41.5	39.9	37.6	34.8	31.9	31.0
180			39.9	38.3	36.3	33.5	30.7	29.8
185					34.9	32.3	29.5	28.6
190					33.6	31.0	28.3	27.7
195						29.9	27.3	26.4
200							26.3	25.4
205								24.4
210								23.6
BOOM ANGLE 65°								
BOOM LENGTH (ft)								
LOAD RAD (ft)	66	85	105	125	144	164	184	203
CAPACITY (Kib)								
140	36.5							
145	34.6	51.1						
150	32.7	48.7						
155	30.9	46.5						
160	28.8	44.4	41.8					
165	26.4	42.5	40.0	37.0				
170	23.9	40.8	38.3	35.5				
175	22.4	38.9	36.6	34.0	30.3			
180	20.8	37.3	35.1	32.5	29.1	25.2		
185	19.7	35.8	33.6	31.2	27.9	24.2		
190		34.3	32.3	29.9	26.8	23.2		
195				28.5	25.8	22.2	18.6	
200				27.4	24.7	21.3	17.8	14.0
205				26.3	23.7	20.4	17.0	13.2
210				25.1	22.9	19.6	16.3	12.6
215					21.9	18.8	15.5	11.9
220						18.0	14.7	11.3
225							14.0	10.7
230								10.1
235								9.6
240								9.1

*This material is supplied for reference only. Operator must refer to Crane Rating Manual and Operator's Manual to determine allowable crane lifting capacities and assembly operating procedures.

(LJ) LUFFING JIB LOAD CHART

SCC8300 217 FT LUFFING JIB									
	2316A + 2825A		282,200 lbs + 125,700 lbs			360°			
BOOM ANGLE 87°									
BOOM LENGTH (ft)									
LOAD RAD (ft)	66	85	105	125	144	164	184	203	
CAPACITY (Kib)									
70	65.6	79.4	77.5		71.7	68.3	64.8		
75	59.2	78.6	76.8	74.1	71.0	67.7	64.3	51.8	
80	54.0	77.8	76.1	73.4	70.4	67.1	63.5	51.2	
85	47.8	77.0	75.4	72.8	69.9	66.6	62.0	49.9	
90	43.9	73.6	74.1	72.2	69.1	64.7	59.9	48.6	
95	41.7	70.2	71.4	71.0	67.7	62.6	57.8	47.4	
100	39.7	66.9	68.0	69.1	65.6	60.4	55.8	46.4	
105	36.4	63.9	65.0	65.9	63.1	58.4	53.8	45.4	
110	34.2	61.2	62.2	63.1	61.2	56.2	51.7	44.4	
115	32.5	58.5	59.6	60.3	59.1	54.1	49.5	43.4	
120	31.5	55.5	57.1	57.7	56.9	51.9	47.4	42.4	
125	31.0	52.0	54.7	55.4	54.6	49.7	45.5	41.3	
130	28.9	48.1	51.5	52.7	52.3	47.7	43.5	40.5	
135	27.9	44.7	47.9	49.5	50.0	45.6	41.6	39.6	
140	27.2	41.1	44.5	46.2	47.3	43.6	39.8	38.6	
145	26.3	37.2	41.1	43.0	44.1	41.7	37.9	37.8	
150	24.9	33.3	38.6	39.8	41.1	39.8	36.0	37.0	
160	19.5	26.7	31.9	34.6	35.3	35.8	32.7	35.7	
170	14.7	22.0	26.6	29.4	30.3	30.9	29.5	32.0	
180	9.8	17.0	21.1	24.0	25.6	26.4	26.7	27.4	
190	6.1	12.9	16.5	19.4	21.3	22.1	22.8	23.0	
BOOM ANGLE 83°									
80	68.1	78.5							
85	64.0	77.8							
90	57.6	77.0	75.9	73.8	70.9				
95	52.3	74.6	75.1	73.2	70.5	67.5	63.3	50.0	
100	47.9	71.2	73.2	72.5	70.0	67.1	64.1	50.0	
105	43.9	67.9	69.2	71.7	69.7	66.8	63.7	49.8	
110	41.5	64.8	64.8	68.5	68.9	66.5	62.7	49.6	
115	38.9	62.0	60.6	65.5	66.4	65.9	60.4	49.5	
120	36.2	59.5	56.8	62.7	63.2	64.3	57.6	48.9	
125	33.3	57.0	53.7	60.0	60.2	61.3	55.0	47.7	
130	30.5	54.6	52.7	57.5	57.7	58.6	52.6	45.7	
135	28.9	51.5	50.1	54.9	55.2	56.1	50.2	43.5	
140	27.3	48.0	47.2	52.4	52.8	53.7	48.0	41.5	
145	25.3	44.4	44.7	50.1	50.7	51.4	46.1	39.6	
150	24.0	41.2	42.5	47.1	48.7	49.3	44.2	37.4	
160	21.9	33.7	38.2	40.8	42.5	44.0	40.7	33.5	
170	19.6	28.9	32.7	34.9	36.7	38.2	37.7	30.4	
180	15.9	22.6	27.7	29.8	31.5	33.1	34.2	28.0	
190	10.3	18.4	23.5	25.2	26.8	28.1	29.3	25.5	
200			18.0	21.1	22.4	23.8	24.8	23.3	
210						19.6	20.9	21.4	

BOOM ANGLE 75°									
BOOM LENGTH (ft)									
LOAD RAD (ft)	66	85	105	125	144	164	184	203	
CAPACITY (Kib)									
120	46.7	64.1							
125	43.7	61.1	59.3						
130	40.1	58.4	56.6						
135	37.8	55.9	54.2	50.7					
140	35.9	53.5	51.9	48.5	45.9				
145	33.7	51.2	49.6	46.5	43.2	39.7	36.4		
150	31.1	49.1	47.6	44.6	41.3	38.0	34.7		
155	29.4	47.1	45.7	42.6	39.6	36.3	33.2	32.5	
160	27.7	44.7	43.8	40.9	38.0	34.8	31.7	31.0	
165	25.9	41.9	42.0	39.2	36.3	33.4	30.3	29.5	
170	24.5	38.8	40.3	37.7	34.8	31.9	29.1	28.2	
175	23.1	36.2	38.8	36.2	33.4	30.6	27.8	27.0	
180	21.6	33.5	37.0	34.7	32.1	29.3	26.7	25.8	
185	20.0	30.9	34.9	33.4	30.8	28.1	25.5	24.6	
190	18.2	28.5	32.4	32.1	29.6	27.0	24.4	23.7	
195	17.2	26.0	29.8	30.8	28.4	26.0	23.3	22.7	
200	14.9	23.8	27.5	29.4	27.4	25.0	22.4	21.6	
210		19.6	22.9	26.0	25.4	22.9	20.5	19.8	
220				21.8	23.4	21.2	18.9	18.1	
230							17.4	16.7	
240								15.2	
BOOM ANGLE 65°									
BOOM LENGTH (ft)									
LOAD RAD (ft)	66	85	105	125	144	164	184	203	
CAPACITY (Kib)									
160	28.8								
165	26.4								
170	23.9								
175	22.3	36.4							
180	20.7	34.8	32.1						
185	19.1	33.1	30.8						
190	18.2	31.8	29.6	26.3					
195	17.2	30.5	28.3	25.1					
200	16.3	29.1	27.0	24.1	20.8				
210	14.3	26.7	24.7	22.0	19.0	15.7	12.3		
220		23.8	22.7	20.3	17.4	14.2	11.0	7.5	
230			20.8	18.6	15.9	12.8	9.7	6.4	
240				17.1	14.5	11.5	8.5	5.4	
250						10.3	7.4	4.3	
260							6.4	3.5	
270								2.5	

*This material is supplied for reference only. Operator must refer to Crane Rating Manual and Operator's Manual to determine allowable crane lifting capacities and assembly operating procedures.

LUFFING JIB ATTACHMENT ON (HH) WORKING RANGE DIAGRAM

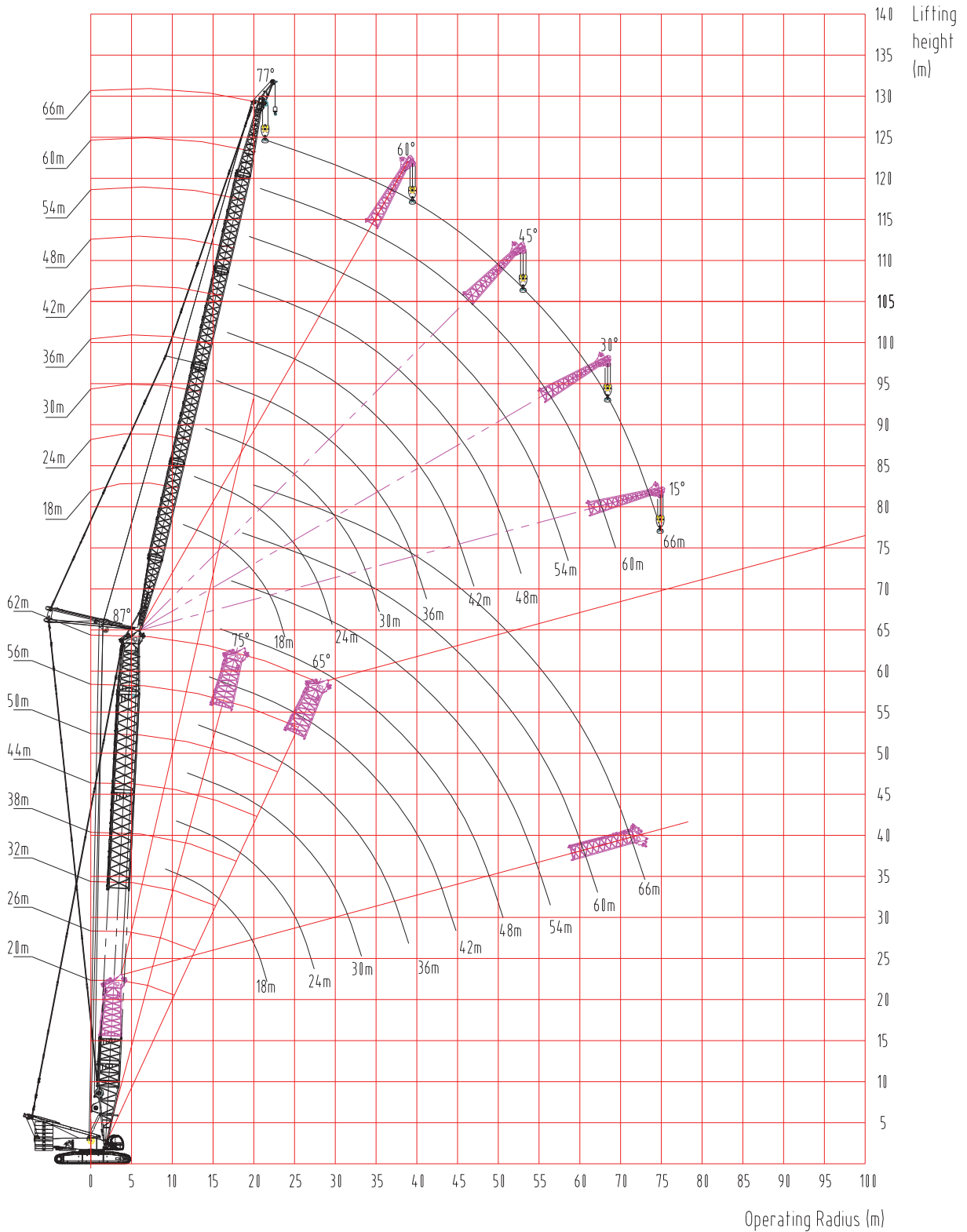

(LJ) LUFFING JIB OPERATING CONDITIONS

2316A Luffing Jib - LJ Configuration			
Boom Length	Insert		
	20' 2316A Center	39' 2316A Center	16' 2316A Suspension
59'	-	-	-
79'	1	-	-
98'	-	1	-
118'	1	1	-
138'	-	2	-
158'	1	2	-
*177'	-	3	-
197'	1	3	-
217'	2	3	1

2825A Boom - LJ Configuration				
Boom Length	Insert			
	10' 2825A Inner	20' 2825A Center	39' 2825A Center I	39' 2825A Center II
66'	1	-	-	-
76'	-	1	-	-
85'	1	1	-	-
95'	-	-	-	1
105'	1	-	-	1
115'	-	1	-	1
125'	1	1	-	1
135'	-	-	-	2
144'	1	-	2	
154'	-	1	-	2
164'	1	1	2	
174'	-	-	1	2
184'	1	-	2	1
194'	-	1	1	2
203'	1	1	2	1

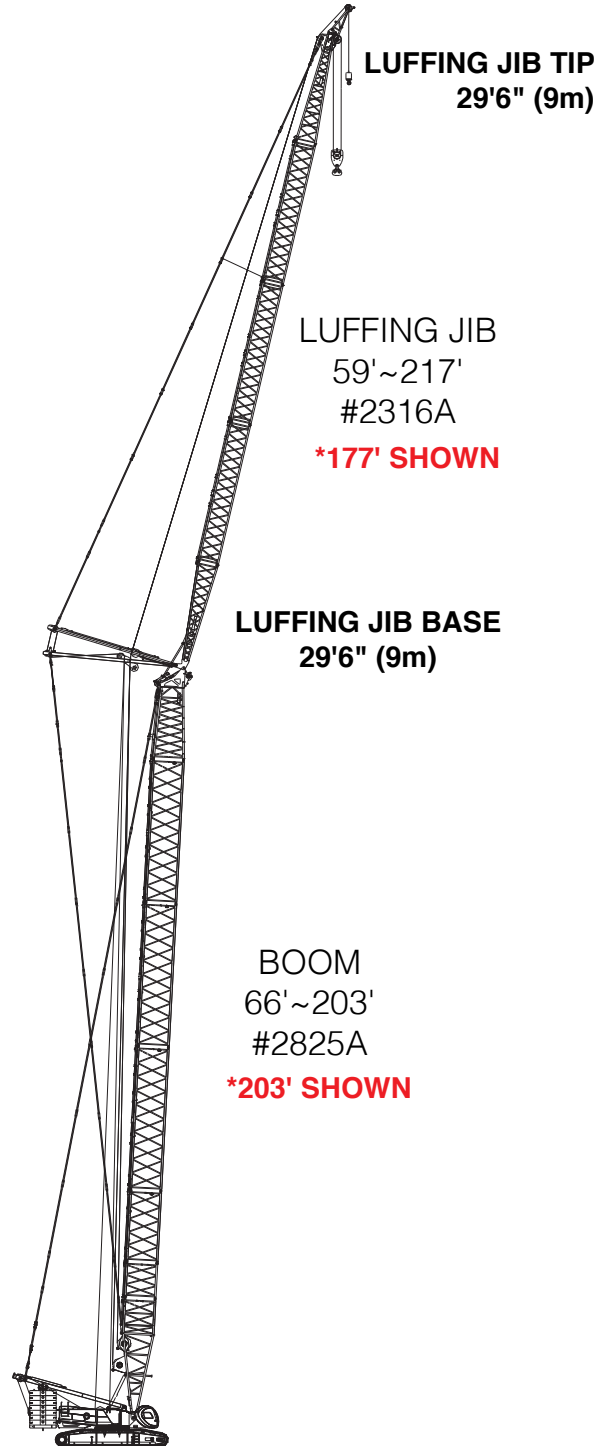



Please visit www.sanyamerica.com to find out more

318 Cooper Circle South | Peachtree City, GA 30269 | Tel: 678-251-2810 | Fax: 770-631-7731

*We are constantly improving our products and therefore reserve the right to change designs and specifications.